

Fittings

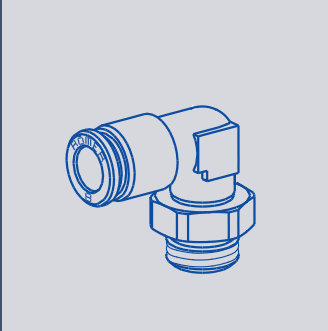

2008

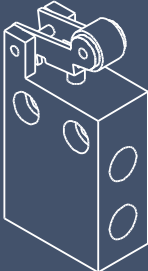
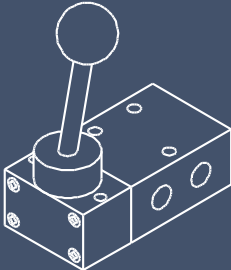
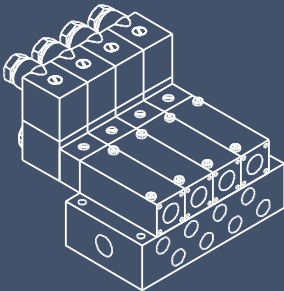
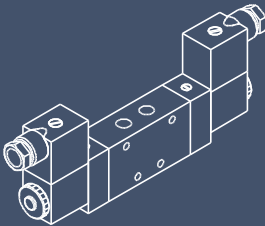

Table of Contents

page 2

page

4.1			Push-in fittings
4	4.1.1	951M	Straight male adaptor
5	4.1.2	946M 930M	Straight female adaptor Elbow male adaptor, swivel, brass
6	4.1.3	930P 979P	Elbow male adaptor, swivel, POM Elbow female adaptor, swivel
7	4.1.4	980P 921P	Elbow male adaptor, swivel, long T male adaptor, swivel, POM
8	4.1.5	921M 992P	T male adaptor, swivel, brass Y male adaptor, swivel
9	4.1.6	922P	L male adaptor with off-set leg, swivel
10	4.1.7	958P 955P	Straight connector Elbow connector
11	4.1.8	954P	T-connector
12	4.1.9	982P 908M	Y-connector Stem adaptor
13	4.1.10	959M 945M	Bulkhead connector Bulkhead adaptor
14	4.1.11	952M 952P	Elbow male adaptor, turn-able, brass Elbow male adaptor, turn-able, POM
15	4.1.12	947M 971P	Reducer Plug
4.2			Push-on fittings
16	4.2.1	151M	Straight male adaptor
17	4.2.2	151M 146M	Straight male adaptor, conical Straight female adaptor
18	4.2.3	130M 130M-D	Elbow male adaptor, swivel Elbow male adaptor, swivel, conical
19	4.2.4	121M 121M	T-male adaptor, swivel T-male adaptor, swivel, conical
20	4.2.5	142M 158M	L-male adaptor with off-set leg, conical Straight connector
21	4.2.6	155M 154M	Elbow connector T-connector
22	4.2.7	145M 156M	Bulkhead adaptor Elbow male adaptor, turn-able
23	4.2.8	152M 153M	Elbow male adaptor, turn-able T male adaptor, turn-able
24	4.2.9	157M	T male adaptor, turn-able
25	4.2.10	151M 130M	Straight male adaptor with spring Elbow male adaptor with spring, swivel
4.3			Accessories
26	4.3.1	260M	Straight male adaptor, push-on, barbed
27	4.3.2	250M 230M	Nipple Nipple, 3-piece
28	4.3.3	251M 252M	Reducing Nipple, male-male Reducer, female-male
29	4.3.4	253M 254M	Reducer male-female Socket female

Fittings

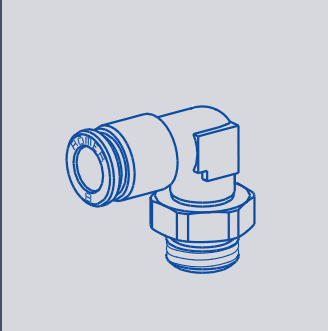
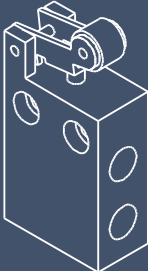

2008

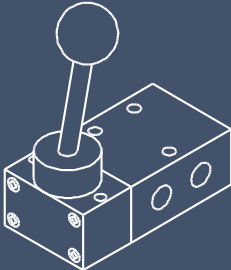
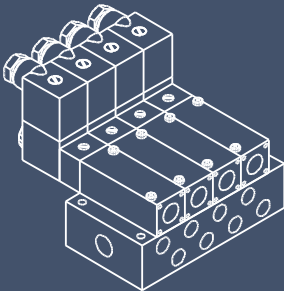
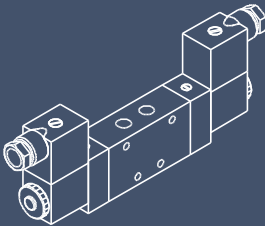

page			
30	4.3.5	255M	Reducer female-female
		257U	Plug
31	4.3.6	262M	Male plug with O-ring seal
		264V	Sealing ring
		265A	Sealing ring
		269N	Sealing ring
4.4		Airline Adaptors	
32	4.4.1	201M	Elbow, female
		202M	Elbow, female-male
		204M	Elbow, male
33	4.4.2	200M	T, female
		206M	T, male-female-female
		216M	Y, male-female-female
34	4.4.3	203M	Cross, female
4.5		Automatic Quick couplings	
35	4.5.1	515M, 518M	Straight plug, male
		535M, 538M	Straight plug, female
		565M, 568M	Straight plug, push-on, barbed
36	4.5.2	545M, 548M	Straight plug, push-on
		585M, 588M	Straight plug, push-on with spiral
		551M, 581M	Straight socket, male
37	4.5.3	553M, 583M	Straight socket, female
		586M	Straight socket, push-on, barbed
		554M	Straight socket, push-on
4.6		Silencers	
38	4.6.1	293U	Silencer, long
		290U	Silencer, short
4.7		Function fittings	
40	4.7.1	SCU, RCU	Exhaust-Air flow control
41	4.7.2	DR, D	Block form flow regulator
42	4.7.3	VNR, VSR	Non-return valve
43	4.7.4	SEA	Quick exhaust valve
		SSC, SVE	Flow control silencer
4.8		Pneumatic tube	
44	4.8.1	CPU	PUR Tube
45	4.8.2	CPA	PA Tube
46	4.8.3	CPT	PTFE Tube
		SPA	Spiral Tube

Push-in fittings

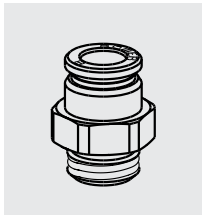

Straight male adaptor

Cylindrical

Material: brass, nickel plated

Seals: NBR

Temperature range: -20°C ... +80°C

Maximum pressure: 20 bar

Stainless steel (AISI 316) with FPM seal on request.

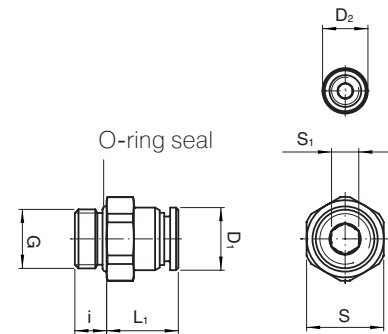

Hose-Ø	Port size G	L1	i	D1	D2	S1	S	Type
4	M 5	16,5	3,5	8		2,5	8	951M-4-M5
4	M 7	15	4,5	8	10	3		951M-4-M7-I
4	G 1/8"	14	5	10		3	13	951M-4-1/8
6	M 5	17,5	3,5	10		2,5	10	951M-6-M5
6	M 7	17	4,5	10	10	3		951M-6-M7-I
6	G 1/8"	15	5	12		4	13	951M-6-1/8
6	G 1/4"	14,5	7	12		4	17	951M-6-1/4
6	G 3/8"	12	8	12		4	19	951M-6-3/8
8	G 1/8"	20	5	14		5	14	951M-8-1/8
8	G 1/4"	16	7	14		6	17	951M-8-1/4
8	G 3/8"	16	8	14		6	19	951M-8-3/8
10	G 1/4"	22	7	16,5		7	17	951M-10-1/4
10	G 3/8"	17,5	8	16,5		8	19	951M-10-3/8
10	G 1/2"	15,5	9	16,5		8	24	951M-10-1/2
12	G 1/4"	25	7	20		7	22	951M-12-1/4
12	G 3/8"	19,5	8	20		10	22	951M-12-3/8
12	G 1/2"	18,5	9	20		10	24	951M-12-1/2
14	G 3/8"	25,5	8	22		10	22	951M-14-3/8
14	G 1/2"	19,5	9	22		12	24	951M-14-1/2
16	G 3/8"	26,5	8	24		10	24	951M-16-3/8
16	G 1/2"	19,5	9	24		12	24	951M-16-1/2
22	G 1/2"	32	9	32			32	951M-22-1/2
22	G 3/4"	31	11	32			32	951M-22-3/4

Other version, conical, self-sealing to be fasted using a hex set on request.

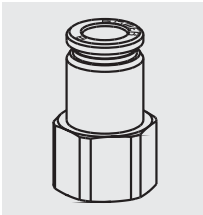

Straight female adaptor

Cylindrical
Material: brass, nickel plated
Seals: NBR
Temperature range: -20°C ...+80°C
Maximum pressure: 20 bar

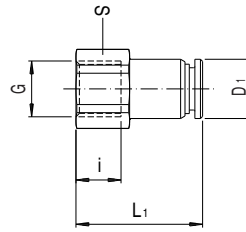

Hose-∅	Port size G	L1	i	D1	S	Type
4	G 1/8"	23,5	8	10	13	946M-4-1/8
6	G 1/8"	25	8	12	13	946M-6-1/8
6	G 1/4"	27,5	10,5	12	17	946M-6-1/4
8	G 1/8"	27	8	14	14	946M-8-1/8
8	G 1/4"	29,5	10,5	14	17	946M-8-1/4
8	G 3/8"	30,5	11,5	14	19	946M-8-3/8
10	G 1/4"	32	10,5	16,5	17	946M-10-1/4
10	G 3/8"	33	11,5	16,5	19	946M-10-3/8
10	G 1/2"	36,5	15	16,5	24	946M-10-1/2

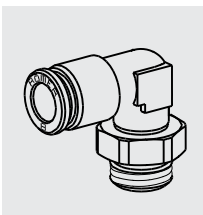

Elbow male adaptor, swivel

Cylindrical
Material: brass, nickel plated
Seals: NBR
Temperature range: -20°C ...+80°C
Maximum pressure: 16 bar

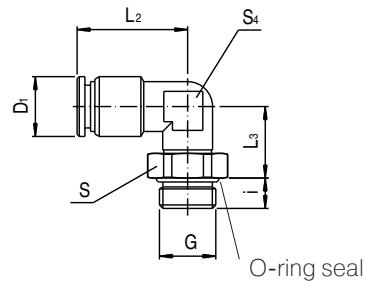

Stainless steel (AISI 316) with FPM seal on request.

Hose-∅	Port size G	L2	L3	i	D1	S4	S	Type
4	G 1/8"	20,5	13,5	5	10	9	13	930M-4-1/8
4	G 1/4"	22	15,5	7	10	10	17	930M-4-1/4
6	G 1/8"	22	13,5	5	12	9	13	930M-6-1/8
6	G 1/4"	23,5	15,5	7	12	10	17	930M-6-1/4
8	G 1/8"	25,5	16	5	14	12	13	930M-8-1/8
8	G 1/4"	27,5	17,5	7	14	13	17	930M-8-1/4
8	G 3/8"	27,5	19,5	8	14	13	19	930M-8-3/8
10	G 1/4"	29,5	17,5	7	16,5	13	17	930M-10-1/4
10	G 3/8"	29,5	19,5	8	16,5	13	19	930M-10-3/8
12	G 3/8"	32	19,5	8	20	17	19	930M-12-3/8
12	G 1/2"	32	21,5	9	20	17	24	930M-12-1/2

Conical version on request.

Push-in fittings

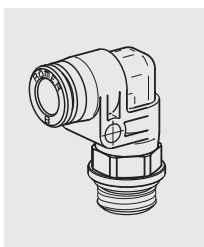

Elbow male adaptor, swivel

Cylindrical
Material: POM, brass, nickel plated
Seals: NBR
Temperature range: -20°C ... +60°C
Maximum pressure: 10 bar

PVDF material with FPM seal on request.

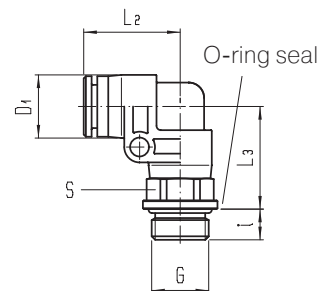

Hose-Ø	Port size G	L2	L3	i	D1	S	Type
4	M 5	17	9	3,5	8	8	930P-4-M5
4	G 1/8"	18,5	20,5	5	12,5	12	930P-4-1/8
4	G 1/4"	18,5	20,5	7	12,5	12	930P-4-1/4
6	M 5	18	10	3,5	10	8	930P-6-M5
6	G 1/8"	19	20,5	5	12,5	12	930P-6-1/8
6	G 1/4"	19	20,5	7	12,5	12	930P-6-1/4
8	G 1/8"	22	22	5	14,5	14	930P-8-1/8
8	G 1/4"	22	23,5	7	14,5	14	930P-8-1/4
8	G 3/8"	22	24	8	14,5	14	930P-8-3/8
10	G 1/4"	26	25,5	7	17	17	930P-10-1/4
10	G 3/8"	26	27	8	17	17	930P-10-3/8
12	G 3/8"	31	30,5	8	23	22	930P-12-3/8
12	G 1/2"	31	31	9	23	24	930P-12-1/2
14	G 1/2"	31	31	9	23	24	930P-14-1/2
16	G 3/8"	32	32	8	25	24	930P-16-3/8
16	G 1/2"	32	32	9	25	24	930P-16-1/2
22	G 1/2"	40	41	9	34	32	930P-22-1/2
22	G 3/4"	40	40	11	34	32	930P-22-3/4

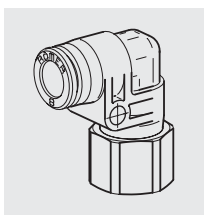

Elbow female adaptor, swivel

Cylindrical
Material: POM, brass, nickel plated
Seals: NBR
Temperature range: -20°C ... +60°C
Maximum pressure: 10 bar

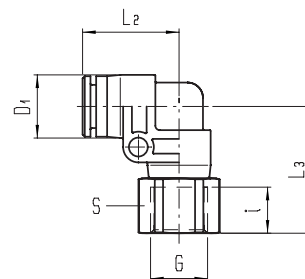

Hose-Ø	Port size G	L2	L3	i	D1	S	Type
4	G 1/8"	18,5	24	8	12,5	13	979P-4-1/8
4	G 1/4"	18,5	26,5	10,5	12,5	17	979P-4-1/4
6	G 1/8"	19	24	8	12,5	13	979P-6-1/8
6	G 1/4"	19	26,5	10,5	12,5	17	979P-6-1/4
8	G 1/8"	22	26,5	8	14,5	14	979P-8-1/8
8	G 1/4"	22	29	10,5	14,5	17	979P-8-1/4

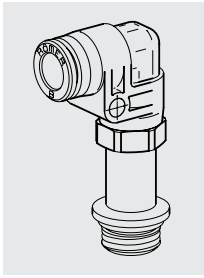

Elbow male adaptor, swivel, long

Cylindrical, long
 Material: POM, brass, nickel plated
 Seals: NBR
 Temperature range: -20°C ...+60°C
 Maximum pressure: 10 bar

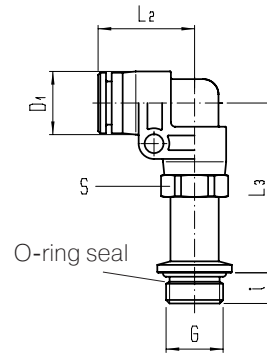

Hose-Ø	Port size G	L2	L3	i	D1	S	Type
4	G 1/8"	18,5	34	5	12,5	12	980P-4-1/8
4	G 1/4"	18,5	34,5	7	12,5	12	980P-4-1/4
6	G 1/8"	19	34	5	12,5	12	980P-6-1/8
6	G 1/4"	19	34,5	7	12,5	12	980P-6-1/4
8	G 1/8"	22	37,5	5	14,5	14	980P-8-1/8
8	G 1/4"	22	39	7	14,5	14	980P-8-1/4
8	G 3/8"	22	39,5	8	14,5	14	980P-8-3/8
10	G 1/4"	26	12,5	7	17	17	980P-10-1/4
10	G 3/8"	26	15,5	8	17	17	980P-10-3/8

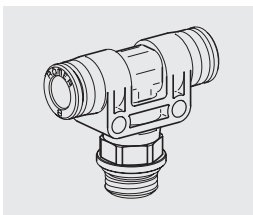

T male adaptor, swivel

Cylindrical
 Material: POM, brass, nickel plated
 Seals: NBR
 Temperature range: -20°C ...+60°C
 Maximum pressure: 10 bar

PVDF material with FPM seals on request.

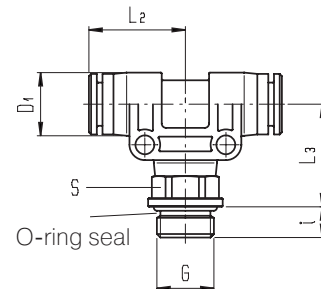

Hose-Ø	Port size G	L2	L3	i	D1	S	Type
4	G 1/8"	18,5	20,5	5	12,5	12	921P-4-1/8
4	G 1/4"	18,5	20,5	7	12,5	12	921P-4-1/4
6	G 1/8"	19	20,5	5	12,5	12	921P-6-1/8
6	G 1/4"	19	20,5	7	12,5	12	921P-6-1/4
8	G 1/8"	22	22	5	14,5	14	921P-8-1/8
8	G 1/4"	22	23,5	7	14,5	14	921P-8-1/4
8	G 3/8"	22	24	8	14,5	14	921P-8-3/8
10	G 1/4"	26	25,5	7	17	17	921P-10-1/4
10	G 3/8"	26	27	8	17	17	921P-10-3/8
12	G 3/8"	31	30,5	8	23	22	921P-12-3/8
12	G 1/2"	31	31	9	23	24	921P-12-1/2
14	G 1/2"	31	31	9	23	24	921P-14-1/2
16	G 3/8"	32	32	8	25	24	921P-16-3/8
16	G 1/2"	32	32	9	25	24	921P-16-1/2
22	G 1/2"	40	41	9	34	32	921P-22-1/2
22	G 3/4"	40	40	11	34	32	921P-22-3/4

Push-in fittings

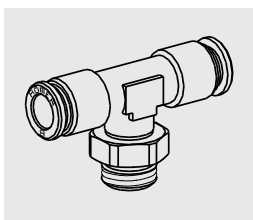

T male adaptor, swivel

Cylindrical
Material: brass, nickel plated
Seals: NBR
Temperature range: -20°C ...+80°C
Maximum pressure: 16 bar

Stainless steel (AISI 316) with FPM seals on request.

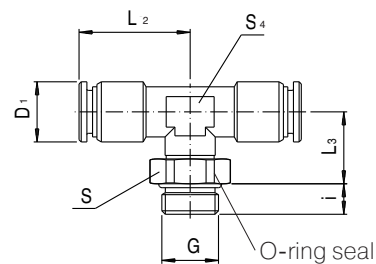

Hose-Ø	Port size G	L2	L3	i	D1	S4	S	Type
4	G 1/8"	20,5	13,5	5	10	9	13	921M-4-1/8
4	G 1/4"	22	15,5	7	10	10	17	921M-4-1/4
6	G 1/8"	22	13,5	5	12	9	13	921M-6-1/8
6	G 1/4"	23,5	15,5	7	12	10	17	921M-6-1/4
8	G 1/8"	25,5	16	5	14	12	13	921M-8-1/8
8	G 1/4"	27,5	17,5	7	14	13	17	921M-8-1/4
8	G 3/8"	27,5	19,5	8	14	13	19	921M-8-3/8
10	G 1/4"	29,5	17,5	7	16,5	13	17	921M-10-1/4
10	G 3/8"	29,5	19,5	8	16,5	13	19	921M-10-3/8
12	G 3/8"	32	19,5	8	20	17	19	921M-12-3/8

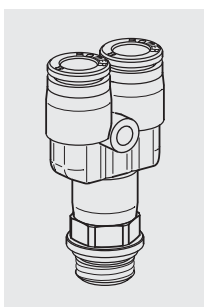

Y male adaptor, swivel

Cylindrical
Material: POM, brass, nickel plated
Seals: NBR
Temperature range: -20°C ...+60°C
Maximum pressure: 10 bar

PVDF material with FPM seals on request.

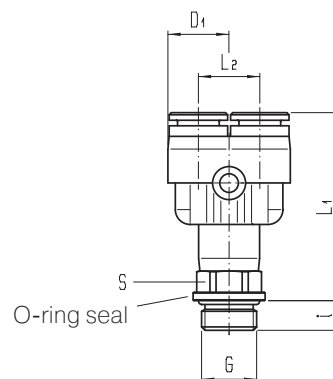

Hose-Ø	Port size G	L1	L2	i	D1	S	Type
4	G 1/8"	39	12,5	5	12,5	12	992P-4-1/8
4	G 1/4"	39	12,5	7	12,5	12	992P-4-1/4
6	G 1/8"	39,5	12,5	5	12,5	12	992P-6-1/8
6	G 1/4"	39,5	12,5	7	12,5	12	992P-6-1/4
8	G 1/8"	43	14,5	5	14,5	14	992P-8-1/8
8	G 1/4"	44,5	14,5	7	14,5	14	992P-8-1/4
8	G 3/8"	45	14,5	8	14,5	14	992P-8-3/8
10	G 1/4"	48,5	17	7	17	17	992P-10-1/4
10	G 3/8"	50	17	8	17	17	992P-10-3/8
12	G 3/8"	55	20,5	8	21	22	992P-12-3/8
12	G 1/2"	55,5	20,5	9	21	24	992P-12-1/2

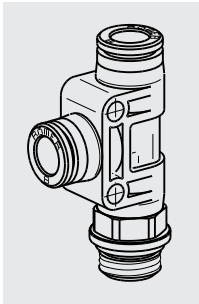

L male adaptor with off-set leg, swivel

Cylindrical
 Material: POM, brass, nickel plated
 Seals: NBR
 Temperature range: -20°C ...+60°C
 Maximum pressure: 10 bar

PVDF material with FPM seals on request.

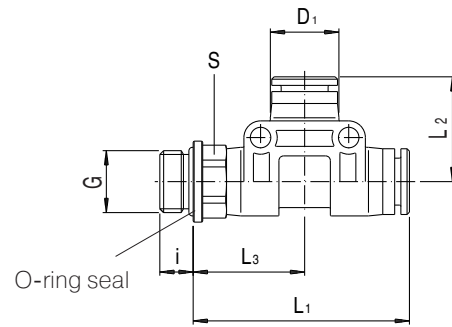

Hose-Ø	Port size G	L1	L2	L3	i	D1	S	Type
4	G 1/8"	39	18,5	20,5	5	12,5	12	922P-4-1/8
4	G 1/4"	39	18,5	20,5	7	12,5	12	922P-4-1/4
6	G 1/8"	39,5	19	20,5	5	12,5	12	922P-6-1/8
6	G 1/4"	39,5	19	20,5	7	12,5	12	922P-6-1/4
8	G 1/8"	44	22	22	5	14,5	14	922P-8-1/8
8	G 1/4"	45,5	22	23,5	7	14,5	14	922P-8-1/4
8	G 3/8"	46	22	24	8	14,5	14	922P-8-3/8
10	G 1/4"	51,5	26	25,5	7	17	17	922P-10-1/4
10	G 3/8"	53	26	27	8	17	17	922P-10-3/8
12	G 3/8"	61,5	31	30,5	8	23	22	922P-12-3/8
12	G 1/2"	62	31	31	9	23	24	922P-12-1/2
14	G 1/2"	62	31	31	9	23	24	922P-14-1/2
16	G 3/8"	64	32	32	8	25	24	922P-16-3/8
16	G 1/2"	64	32	32	9	25	24	922P-16-1/2
22	G 1/2"	81	40	41	9	34	32	922P-22-1/2
22	G 3/4"	80	40	40	11	34	32	922P-22-3/4

Push-in fittings

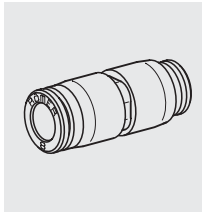

Straight connector

Material: POM
 Seals: NBR
 Temperature range: -20°C ...+60°C
 Maximum pressure: 10 bar

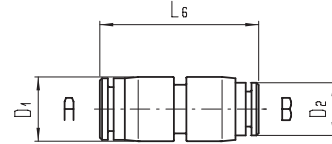

PVDF material with FPM seals on request.
 Nickel plated brass version on request.

Hose-Ø A	Hose-Ø B	L6	D1	D2	Type
4	4	31	12,5	12,5	958P-4
6	4	31,5	12,5	12,5	958P-6-4
6	6	32	12,5	12,5	958P-6
8	4	35,5	14,5	14,5	958P-8-4
8	6	35,5	14,5	14,5	958P-8-6
8	8	36	14,5	14,5	958P-8
10	6	40	17	17	958P-10-6
10	8	40,5	17	17	958P-10-8
10	10	41	17	17	958P-10
12	10	46	23	23	958P-12-10
12	12	46	23	23	958P-12
14	12	46	23	23	958P-14-12
14	14	46	23	23	958P-14
16	12	47	25	25	958P-16-12
16	14	47	25	25	958P-16-14
16	16	47	25	25	958P-16
22	22	57	34	34	958P-22

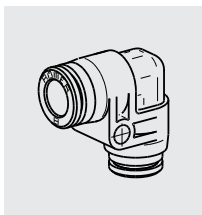

Elbow connector

Material: POM
 Seals: NBR
 Temperature range: -20°C ...+60°C
 Maximum pressure: 10 bar

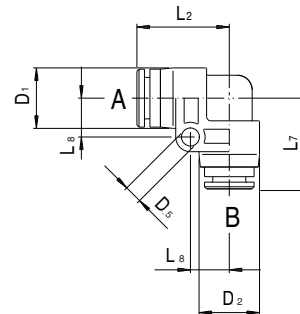

PVDF material with FPM seals on request.
 Nickel plated brass version or stainless steel (AISI 316) with FPM seal on request.

Hose-Ø A	Hose-Ø B	L2	L7	L8	D1	D2	D5	Type
4	4	18,5	18,5	8,3	12,5	12,5	4,3	955P-4
6	4	19	18,5	8,3	12,5	12,5	4,3	955P-6-4
6	6	19	19	8,3	12,5	12,5	4,3	955P-6
8	6	22	21,5	9,3	14,5	14,5	4,3	955P-8-6
8	8	22	22	9,3	14,5	14,5	4,3	955P-8
10	6	26	25	12	17	17	4,3	955P-10-6
10	8	26	25,5	12	17	17	4,3	955P-10-8
10	10	26	26	12	17	17	4,3	955P-10
12	12	31	31	12	23	23	4,3	955P-12
14	14	31	31	12	23	23	4,3	955P-14
16	16	32	32	12	25	25	4,3	955P-16
22	22	40	40	16	34	34	5,4	955P-22

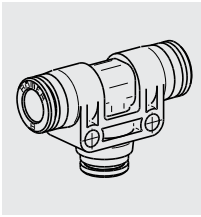

T - connector

Material: POM
 Seals: NBR
 Temperature range: -20°C ...+60°C
 Maximum pressure: 10 bar

PVDF material with FPM seals on request.
 Nickel plated brass version or stainless steel (AISI 316) with FPM seal on request.

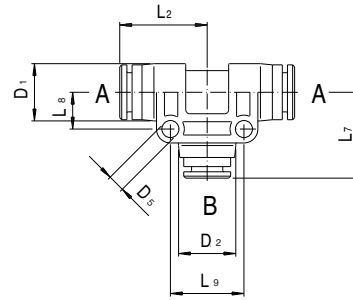

Hose-Ø A	Hose-Ø B	L2	L7	L8	L9	D1	D2	D5	Type
4	4	18,5	18,5	8,3	16,5	12,5	12,5	4,3	954P-4
4	6	18,5	19	8,3	16,5	12,5	12,5	4,3	954P-4-6
6	4	19	18,5	8,3	16,5	12,5	12,5	4,3	954P-6-4
6	6	19	19	8,3	16,5	12,5	12,5	4,3	954P-6
6	8	21,5	22	9,3	18,5	14,5	14,5	4,3	954P-6-8
8	6	22	21,5	9,3	18,5	14,5	14,5	4,3	954P-8-6
8	8	22	22	9,3	18,5	14,5	14,5	4,3	954P-8
8	10	25,5	26	12	24	17	17	4,3	954P-8-10
10	6	26	25	12	24	17	17	4,3	954P-10-6
10	8	26	25,5	12	24	17	17	4,3	954P-10-8
10	10	26	26	12	24	17	17	4,3	954P-10
10	12	31	31	12	24	23	23	4,3	954P-10-12
12	10	31	31	12	24	23	23	4,3	954P-12-10
12	12	31	31	12	24	23	23	4,3	954P-12
14	14	31	31	12	24	23	23	4,3	954P-14
16	16	32	32	12	24	25	25	4,3	954P-16
22	16	40	39,5	16	32	34	34	5,4	954P-22-16
22	22	40	40	16	32	34	34	5,4	954P-22

Push-in fittings

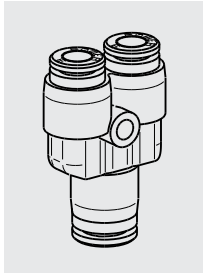

Y - connector

Material: POM
Seals: NBR
Temperature range: -20°C ...+60°C
Maximum pressure: 10 bar

PVDF material with FPM seals on request.

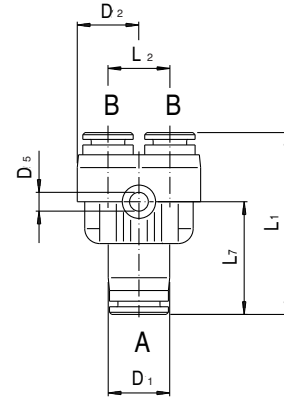

Hose-Ø A	Hose-Ø B	L1	L2	L7	D1	D2	D5	Type
4	4	37	12,5	22,5	12,5	12,5	3,3	982P-4
6	4	37,5	12,5	23	12,5	12,5	3,3	982P-6-4
6	6	38	12,5	23	12,5	12,5	3,3	982P-6
8	4	42,5	14,5	26,5	14,5	14,5	3,3	982P-8-4
8	6	43	14,5	26,5	14,5	14,5	4,3	982P-8-6
8	8	43	14,5	26,5	14,5	14,5	4,3	982P-8
10	8	48,5	17	31	17	17	4,3	982P-10-8
10	10	49	17	31	17	17	4,3	982P-10
12	8	54,5	20,5	35,5	23	23	4,3	982P-12-8
12	10	54,5	20,5	35,5	23	23	4,3	982P-12-10
12	12	54,5	20,5	35,5	23	23	4,3	982P-12

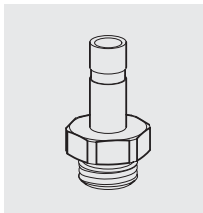

Stem Adaptor

Cylindrical
Material: brass
Seals: NBR
Temperature range: -20°C ...+80°C
Maximum pressure: 20 bar

Stainless steel (AISI 316) with FPM
O-ring on request.

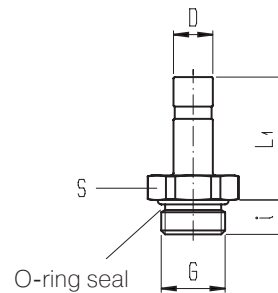

Connector D	Port size G	L1	i	S	Type
6	G 1/8"	22,5	5	13	908M-6-1/8
6	G 1/4"	23	7	17	908M-6-1/4
8	G 1/4"	25	7	17	908M-8-1/4
10	G 1/4"	29	7	17	908M-10-1/4
10	G 3/8"	29	8	19	908M-10-3/8
12	G 3/8"	31	8	19	908M-12-3/8
12	G 1/2"	31,5	9	24	908M-12-1/2
14	G 1/2"	32	9	24	908M-14-1/2
16	G 1/2"	32,5	9	24	908M-16-1/2

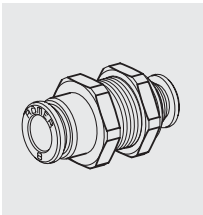

Bulkhead connector

Material: brass, nickel plated
 Seals: NBR
 Temperature range: -20°C ...+80°C
 Maximum pressure: 20 bar

POM material on request.
 PVDF material on request.

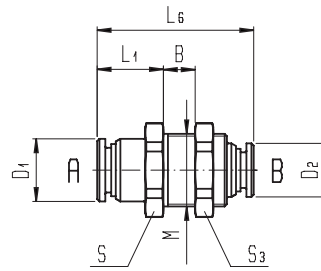

Hose-Ø A	Hose-Ø B	M	B	L1	L6	D1	D2	S1	S3	Type
4	4	M12x1	1-10	11	30	10	10	14	17	959M-4
6	4	M14x1	1-10	12,5	31,5	12	10	17	17	959M-6-4
6	6	M14x1	1-10	13,5	32,5	12	12	17	17	959M-6
8	6	M16x1	1-10	14,5	34,5	14	12	19	19	959M-8-6
8	8	M16x1	1-10	16,5	36,5	14	14	19	19	959M-8
10	8	M20x1	1-10	19	39	16,5	14	22	24	959M-10-8
10	10	M20x1	1-10	20,5	42	16,5	16,5	22	24	959M-10
12	12	M22x1,5	1-10	22	45,5	20	20	24	27	959M-12
14	14	M24x1,5	1-10	23	46,5	22	22	27	27	959M-14

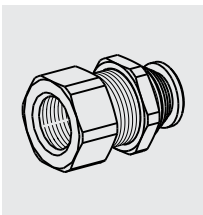

Bulkhead adaptor

Material: brass, nickel plated
 Seals: NBR
 Temperature range: -20°C ...+80°C
 Maximum pressure: 20 bar

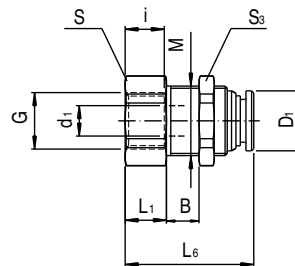

Hose-Ø	Port size G	M	B	L1	I	L6	d1	D1	S	S3	Type
4	G 1/8"	M12x1	1-9	6,5	8	25	3	10	14	17	945M-4-1/8
6	G 1/8"	M14x1	1-9	6,5	8	25,5	5	12	17	17	945M-6-1/8
6	G 1/4"	M14x1	1-9	12	10,5	31	5	12	17	17	945M-6-1/4
8	G 1/8"	M16x1	1-9	7	8	27	7	14	19	19	945M-8-1/8
8	G 1/4"	M16x1	1-9	9,5	10,5	29,5	7	14	19	19	945M-8-1/4
10	G 1/4"	M20x1	1-9	11	10,5	32	9	16,5	22	24	945M-10-1/4
10	G 3/8"	M20x1	1-9	12	11,5	33	9	16,5	22	24	945M-10-3/8
22	G 3/4"	M33x1,5	1-9	18	18	48	20	32	36	41	945M-22-3/4

Push-in fittings

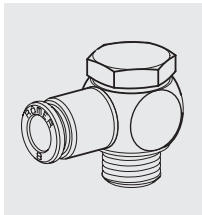

Elbow male adaptor, turn-able

Cylindrical
Material: brass, nickel plated
Seals: NBR, PA
Temperature range: -20°C ...+80°C
Maximum pressure: 20 bar

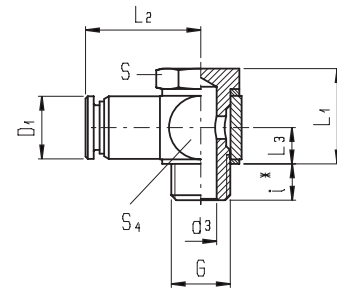

Hose-Ø	Port size G	L1	i	L2	L3	d3	D1	S4	S	Type
4	M 5	14	4	17	5,3	2	8	9	8	952M-4-M5N
4	G 1/8"	20	6,5	20,5	8	5	10	14	14	952M-4-1/8N
6	M 5	15	4	18,5	5,8	2	10	10	8	952M-6-M5N
6	G 1/8"	20	6,5	21,5	8	5	12	14	14	952M-6-1/8N
6	G 1/4"	21	8	23,5	8	7	12	18	17	952M-6-1/4N
8	G 1/8"	20	6,5	23,5	8	5	14	14	14	952M-8-1/8N
8	G 1/4"	21	8	25,5	8	7	14	18	17	952M-8-1/4N

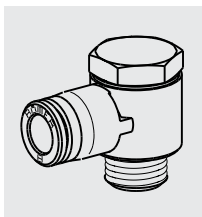

Elbow male adaptor, turn-able

Cylindrical
Material: POM, brass, nickel plated
Seals: NBR
Temperature range: -20°C ...+60°C
Maximum pressure: 10 bar

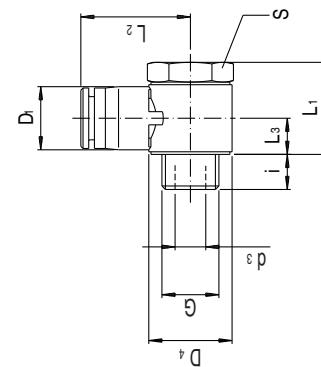

Hose-Ø	Port size G	L1	i	L2	L3	d3	D1	D4	S	Type
4	M 5	14	4	17	5,3	2	8	9	8	952P-4-M5
4	G 1/8"	20	6,5	22	8	5	14,5	15	14	952P-4-1/8
6	M 5	14	4	18	5,3	2	10	9	8	952P-6-M5
6	G 1/8"	20	6,5	22,5	8	5	14,5	15	14	952P-6-1/8
6	G 1/4"	21	8	24,5	8	7	14,5	19	17	952P-6-1/4
8	G 1/8"	20	6,5	23	8	5	14,5	15	14	952P-8-1/8
8	G 1/4"	21	8	25	8	7	14,5	19	17	952P-8-1/4
8	G 3/8"	26,5	9	28,5	11	9,5	17	22,5	19	952P-8-3/8
10	G 1/4"	25	8	27,5	10	7	17	19	17	952P-10-1/4
10	G 3/8"	26,5	9	29	11	9,5	17	22,5	19	952P-10-3/8
10	G 1/2"	27	9	29	11	12	21	27	27	952P-10-1/2
12	G 3/8"	26,5	9	31	11	9,5	21	22,5	19	952P-12-3/8
12	G 1/2"	27	10	33	11	12	21	27	27	952P-12-1/2
14	G 1/2"	31,5	10	34	13	12	25	27	27	952P-14-1/2
16	G 1/2"	31,5	10	34	13	12	25	27	27	952P-16-1/2

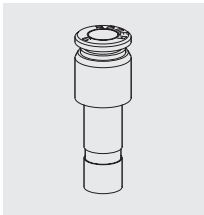

Reducer

Material: brass, nickel plated
 Temperature range: -20°C ...+80°C
 Maximum pressure: 20 bar

* approximately when assembled into a push-in fitting.

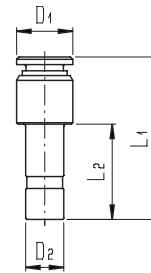

Hose-Ø	Connector D2	l	L1	L5	D1	Type
4	6	18	31,5	17	10	947M-4-D6
6	8	20	34	18,5	12	947M-6-D8
6	10	24	38	20	12	947M-6-D10
8	10	24	39	21	14	947M-8-D10
8	12	26	41	21,5	14	947M-8-D12
8	14	26,5	40	19,5	14	947M-8-D14
10	12	26	42,5	23	16,5	947M-10-D12
10	14	26,5	43	22,5	16,5	947M-10-D14
12	14	26,5	50	29,5	20	947M-12-D14

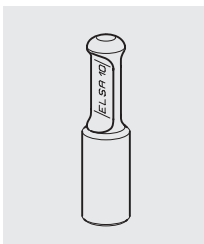

Plug

Material: POM

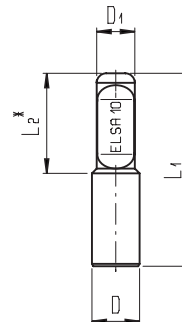

Diameter	L1	L2	D1	Type
4	31,5	16,5	6	971P-4
6	34,5	19,5	8	971P-6
8	37,5	20	8	971P-8
10	40,5	21	8	971P-10
12	44	22	8	971P-12
14	44,5	23	8	971P-14
16	45	24	8	971P-16

Push-on fittings

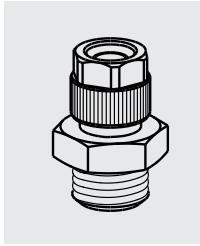

Straight male adaptor

Cylindrical

Material: brass, nickel plated

Minimum Temp.: -40°C

Maximum pressure: 25 bar

Stainless steel (AISI 316) on request.

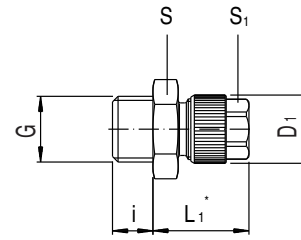

* L1 = approximate dimension

Hose-Ø	Port size G	L1	i	D1	S1	S	Type
4,3/3	M5	14,5	4	8	7	8	151M-4,3/3-M5
4,3/3	G 1/8"	15,5	6	8	7	13	151M-4,3/3-1/8
5/3	M5	14,5	4	8	7	8	151M-5/3-M5
5/3	M6	14,5	5	8	7	8	151M-5/3-M6
5/3	G 1/8"	15,5	6	8	7	13	151M-5/3-1/8
6/4	M5	15,5	4	9	8	8	151M-6/4-M5
6/4	M6	15,5	5	9	8	8	151M-6/4-M6
6/4	G 1/8"	18,5	6	11,5	10	13	151M-6/4-1/8
6/4	G 1/4"	19	8	11,5	10	17	151M-6/4-1/4
6/4	G 3/8"	19	9	11,5	10	19	151M-6/4-3/8
6/4	G 1/2"	19,5	10	11,5	10	24	151M-6/4-1/2
8/6	G 1/8"	18,5	6	13,5	12	13	151M-8/6-1/8
8/6	G 1/4"	19	8	13,5	12	17	151M-8/6-1/4
8/6	G 3/8"	19	9	13,5	12	19	151M-8/6-3/8
8/6	G 1/2"	19,5	10	13,5	12	24	151M-8/6-1/2
10/8	G 1/8"	20	6	15,5	13	14	151M-10/8-1/8
10/8	G 1/4"	20,5	8	15,5	13	17	151M-10/8-1/4
10/8	G 3/8"	20,5	9	15,5	13	19	151M-10/8-3/8
10/8	G 1/2"	21	10	15,5	13	24	151M-10/8-1/2
12/9	G 1/4"	22	8	17,5	15	17	151M-12/9-1/4
12/9	G 3/8"	22	9	17,5	15	19	151M-12/9-3/8
12/10	G 3/8"	22	9	17,5	15	19	151M-12/10-3/8
12/10	G 1/2"	22,5	10	17,5	15	24	151M-12/10-1/2

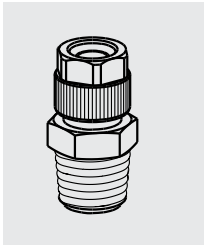

Straight male adaptor

Conical, self sealing

Material: brass, nickel plated

Minimum Temp.: -40°C

Maximum pressure: 25 bar

Stainless steel (AISI 316) on request.

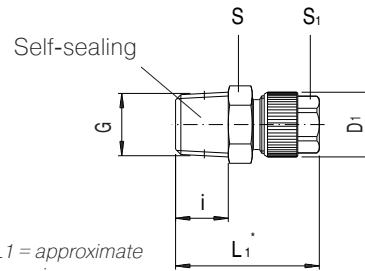

* L1 = approximate dimension

Hose-Ø	Port size G	L1	i	D1	S1	S	Type
6/4	1/8" K	26	8	11,5	10	12	151M-6/4-D1/8K
6/4	1/4" K	30	11	11,5	10	14	151M-6/4-D1/4K
8/6	1/8" K	26	8	13,5	12	12	151M-8/6-D1/8K
8/6	1/4" K	30	11	13,5	12	14	151M-8/6-D1/4K
8/6	3/8" K	31	12	13,5	12	17	151M-8/6-D3/8K
10/8	1/4" K	32	11	15,5	13	14	151M-10/8-D1/4K

Kérésre, öntömítő anyag nélkül is szállítható.

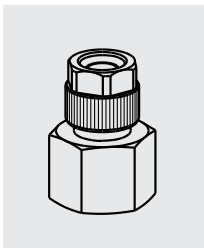

Straight female adaptor

Cylindrical

Material: brass, nickel plated

Minimum Temp.: -40°C

Maximum pressure: 25 bar

Stainless steel (AISI 316) on request.

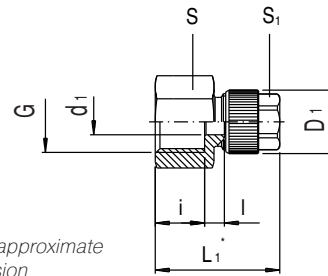

* L1 = approximate dimension

Hose-Ø	Port size G	L1	i	l	d1	D1	S1	S	Type
4,3/3	G 1/8"	21	8		2,3	8	7	13	146M-4,3/3-1/8
5/3	G 1/8"	21	8		2,3	8	7	13	146M-5/3-1/8
6/4	G 1/8"	24	8		5,5	11,5	10	13	146M-6/4-1/8
6/4	G 1/4"	26,5	10,5	7	5,5	11,5	10	17	146M-6/4-1/4
8/6	G 1/8"	24	8	7	5,5	13,5	12	13	146M-8/6-1/8
8/6	G 1/4"	26,5	10,5	7	5,5	13,5	12	17	146M-8/6-1/4
8/6	G 3/8"	27,5	11,5	7	6,5	13,5	12	19	146M-8/6-3/8
8/6	G 1/2"	31,5	15	7	6,5	13,5	12	24	146M-8/6-1/2
10/8	G 1/4"	28	10,5		7	15,5	13	17	146M-10/8-1/4
10/8	G 3/8"	29	11,5		7	15,5	13	19	146M-10/8-3/8
10/8	G 1/2"	33	15		7	15,5	13	24	146M-10/8-1/2
12/9	G 3/8"	31	11,5		7,5	17,5	15	19	146M-12/9-3/8

Push-on fittings

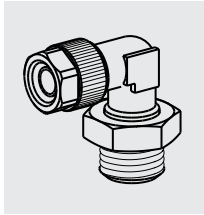

Elbow male adaptor, swivel

Cylindrical
Material: brass, nickel plated
Seals: NBR
Temperature range: -20°C ... +80°C
Maximum pressure: 12 bar

Stainless steel (AISI 316) with FPM seals on request.

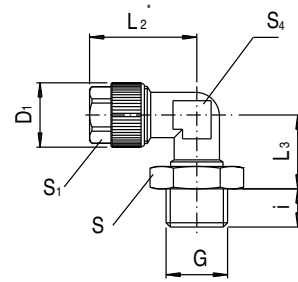

* L2 = approximate dimension

Hose-Ø	Port size G	L2	L3	i	D1	S1	S4	S	Type
6/4	G 1/8"	22,5	14,5	6	11,5	10	10	13	130M-6/4-1/8
6/4	G 1/4"	22,5	14,5	8	11,5	10	10	17	130M-6/4-1/4
8/6	G 1/8"	22,5	14,5	6	13,5	12	10	13	130M-8/6-1/8
8/6	G 1/4"	22,5	14,5	8	13,5	12	10	17	130M-8/6-1/4
10/8	G 1/4"	23,5	14,5	8	13,5	13	10	17	130M-10/8-1/4

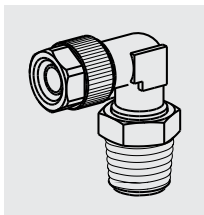

Elbow male adaptor, swivel

Conical, self sealing
Material: brass, nickel plated
Seals: NBR
Temperature range: -20°C ... +80°C
Maximum pressure: 12 bar

Stainless steel (AISI 316) with FPM seals on request.

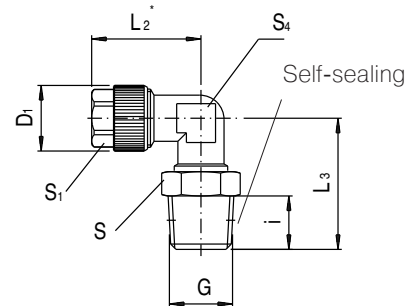

* L2 = approximate dimension

Hose-Ø	Port size G	L2	L3	i	D1	S1	S4	S	Type
6/4	1/8" K	22,5	22,5	7,5	11,5	10	10	13	130M-6/4-D1/8K
6/4	1/4" K	22,5	22,5	11	11,5	10	10	14	130M-6/4-D1/4K
8/6	1/8" K	22,5	22,5	7,5	13,5	12	10	13	130M-8/6-D1/8K
8/6	1/4" K	22,5	22,5	11	13,5	12	10	14	130M-8/6-D1/4K
10/8	1/4" K	23,5	25,5	11	15,5	13	10	14	130M-10/8-D1/4K

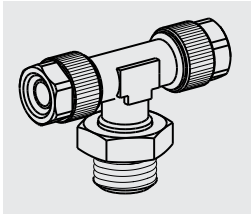

T male adaptor, swivel

Cylindrical
Material: brass, nickel plated
Seals: NBR
Temperature range: -20°C ... +80°C
Maximum pressure: 12 bar

Stainless steel (AISI 316) with FPM seals on request.

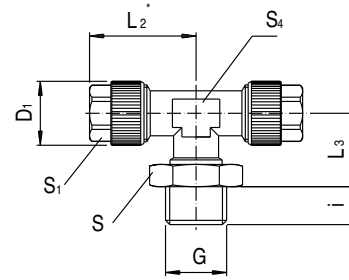

* L2 = approximate dimension

Hose-Ø	Port size G	L2	L3	i	D1	S1	S4	S	Type
6/4	G 1/8"	22,5	14,5	6	11,5	10	10	13	121M-6/4-1/8
6/4	G 1/4"	22,5	14,5	8	11,5	10	10	17	121M-6/4-1/4
8/6	G 1/8"	22,5	14,5	6	13,5	12	10	13	121M-8/6-1/8
8/6	G 1/4"	22,5	14,5	8	13,5	12	10	17	121M-8/6-1/4
10/8	G 1/4"	24	14,5	8	15,5	13	10	17	121M-10/8-1/4

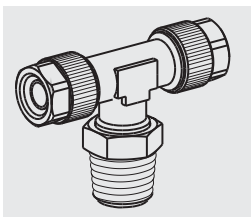

T male adaptor, swivel

Conical, self sealing
Material: brass, nickel plated
Seals: NBR
Temperature range: -20°C ... +80°C
Maximum pressure: 12 bar

Stainless steel (AISI 316) with FPM seals on request.

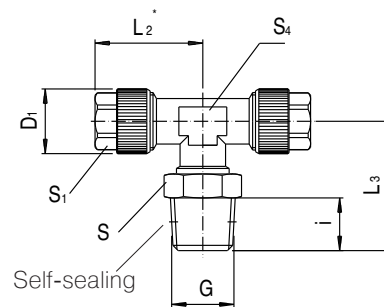

* L2 = approximate dimension

Hose-Ø	Port size G	L2	L3	i	D1	S1	S4	S	Type
6/4	1/8" K	22,5	21,5	7,5	11,5	10	10	13	121M-6/4-D1/8K
6/4	1/4" K	22,5	25,5	11	11,5	10	10	14	121M-6/4-D1/4K
8/6	1/8" K	22,5	21,5	7,5	13,5	12	10	13	121M-8/6-D1/8K
8/6	1/4" K	22,5	25,5	11	13,5	12	10	14	121M-8/6-D1/4K
10/8	1/4" K	24	25,5	11	15,5	13	10	14	121M-10/8-D1/4K

Push-on fittings

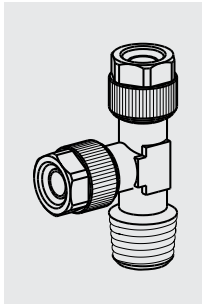

L male adaptor with off-set leg

Conical
Material: brass, nickel plated
Minimum Temp.: -40°C
Maximum pressure: 25 bar

Stainless steel (AISI 316) on request.

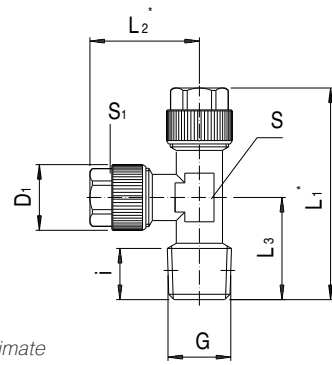

* L1 and L2 = approximate dimensions

Hose-Ø	Port size G	L1	L2	L3	i	D1	S1	S	Type
4,3/3	1/8" K	35	18	17	7,5	8	7	8	142M-4,3/3-1/8K
5/3	1/8" K	35	18	17	7,5	8	7	8	142M-5/3-1/8K
6/4	1/8" K	38,5	21,5	17	7,5	11,5	10	8	142M-6/4-1/8K
6/4	1/4" K	43,5	22,5	21	10,5	11,5	10	10	142M-6/4-1/4K
8/6	1/8" K	38,5	21,5	17	7,5	13,5	12	8	142M-8/6-1/8K
8/6	1/4" K	43,5	22,5	21	10,5	13,5	12	10	142M-8/6-1/4K
10/8	1/8" K	41	24	17	7,5	15,5	13	10	142M-10/8-1/8K
10/8	1/4" K	45	24	21	10,5	15,5	13	10	142M-10/8-1/4K
10/8	3/8" K	54	29	25	11,5	15,5	13	13	142M-10/8-3/8K
12/10	3/8" K	54	29	25	11,5	17,5	15	13	142M-12/10-3/8K

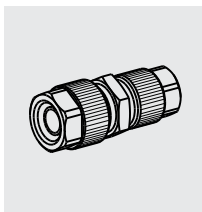

Straight connector

Material: brass, nickel plated
Minimum Temp.: -40°C
Maximum pressure: 25 bar

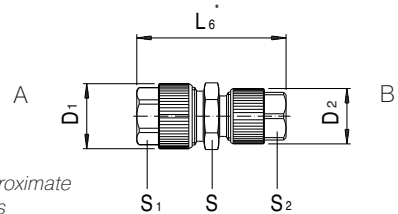

* L6 = approximate dimensions

Hose-Ø A	Hose-Ø B	L6	D1	S1	D2	S2	S	Type
4,3/3	4,3/3	25	8	7	8	7	8	158M-4,3/3
5/3	4,3/3	25	8	7	8	7	8	158M-5/3-4,3/3
5/3	5/3	25	8	7	8	7	8	158M-5/3
6/4	4,3/3	29	11,5	10	8	8	12	158M-6/4-4,3/3
6/4	5/3	29	11,5	10	8	8	12	158M-6/4-5/3
6/4	6/4	31	11,5	10	11,5	10	12	158M-6/4
8/6	6/4	31	13,5	12	11,5	10	12	158M-8/6-6/4
8/6	8/6	31	13,5	12	13,5	12	12	158M-8/6
10/8	6/4	34	15,5	13	11,5	10	14	158M-10/8-6/4
10/8	8/6	34	15,5	13	13,5	12	14	158M-10/8-8/6
10/8	10/8	35	15,5	13	15,5	13	14	158M-10/8
12/10	12/10	38	17,5	15	17,5	15	17	158M-12/10

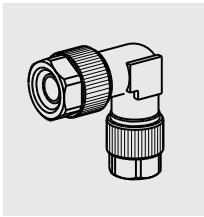

Elbow connector

Material: brass, nickel plated
 Minimum Temp.: -40°C
 Maximum pressure: 25 bar

Stainless steel (AISI 316) on request.

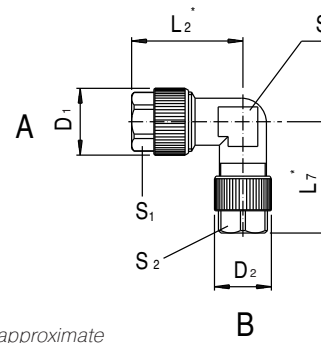

* L₂ and L₇ = approximate dimensions

Hose-Ø A	Hose-Ø B	L ₂	L ₇	D ₁	S ₁	D ₂	S ₂	S	Type
4,3/3	4,3/3	18	18	8	7	8	7	8	155M-4,3/3
5/3	4,3/3	18	18	8	7	8	7	8	155M-5/3-4,3/3
5/3	5/3	18	18	8	7	8	7	8	155M-5/3
6/4	6/4	21,5	21,5	11,5	10	11,5	10	8	155M-6/4
8/6	6/4	22,5	22,5	13,5	12	11,5	10	10	155M-8/6-6/4
8/6	8/6	22,5	22,5	13,5	12	13,5	12	10	155M-8/6
10/8	10/8	24	24	15,5	13	15,5	13	10	155M-10/8
12/10	12/10	29	29	17,5	15	17,5	15	13	155M-12/10

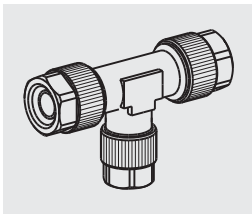

T connector

Material: brass, nickel plated
 Minimum Temp.: -40°C
 Maximum pressure: 25 bar

Stainless steel (AISI 316) on request.

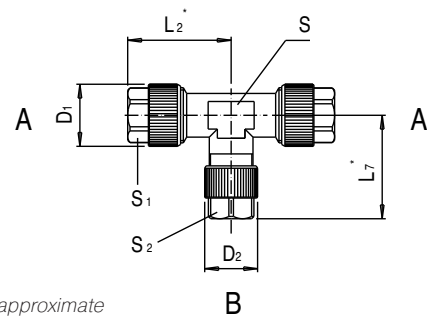

* L₂ and L₇ = approximate dimensions

Hose-Ø A	Hose-Ø B	L ₂	L ₇	D ₁	S ₁	D ₂	S ₂	S	Type
4,3/3	4,3/3	18	18	8	7	8	7	8	154M-4,3/3
5/3	4,3/3	18	18	8	7	8	7	8	154M-5/3-4,3/3
5/3	5/3	18	18	8	7	8	7	8	154M-5/3
6/4	6/4	21,5	21,5	11,5	10	11,5	10	8	154M-6/4
8/6	6/4	21,5	21,5	13,5	12	11,5	10	8	154M-8/6-6/4
8/6	8/6	21,5	21,5	13,5	12	13,5	12	8	154M-8/6
10/8	6/4	24	23	15,5	13	11,5	10	10	154M-10/8-6/4
10/8	8/6	24	23	15,5	13	13,5	12	10	154M-10/8-8/6
10/8	10/8	24	24	15,5	13	15,5	13	10	154M-10/8
12/9	12/9	29	29	17,5	15	17,5	15	13	154M-12/9
12/10	12/10	29	29	17,5	15	17,5	15	13	154M-12/10

Push-on fittings

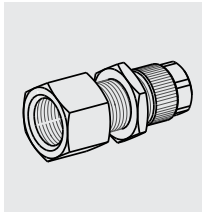

Bulkhead adaptor

Material: brass, nickel plated
 Minimum Temp.: -40°C
 Maximum pressure: 25 bar

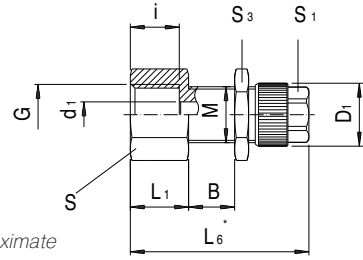

* L6 = approximate dimension

Hose-Ø	Port size G	M	B	L1	L6	i	d1	D1	S1	S3	S	Type
4,3/3	M5	M7x0,75	1-9	7	28	5	2,2	8	7	10	8	145M-4,3/3-M5
5/3	M5	M7x0,75	1-9	7	28	5	2,2	8	7	10	8	145M-5/3-M5
6/4	G 1/8"	M10x1	1-9	10	35,8	8	3,3	11,5	10	13	13	145M-6/4-1/8
8/6	G 1/4"	M12x1	1-9	12,5	38,3	10,5	5,5	13,5	12	17	17	145M-8/6-1/4
10/8	G 1/4"	M14x1	1-9	12,5	40,3	10,5	7	15,5	13	17	17	145M-10/8-1/4
12/9	G 3/8"	M16x1	1-9	13,5	42,3	11,5	7,6	17,5	15	19	19	145M-12/9-3/8

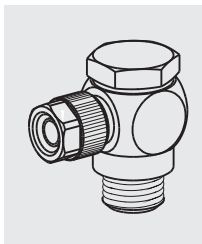

Elbow male adaptor, turn-able

Cylindrical, long
 Material: brass, nickel plated
 Seals: NBR, PA
 Minimum Temp.: -40°C
 Maximum pressure: 25 bar

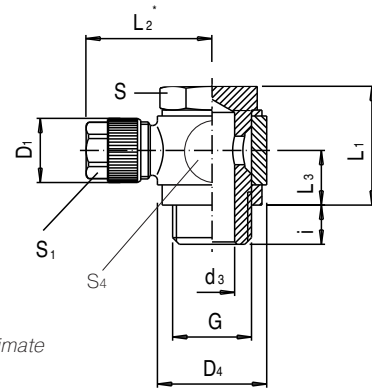

* L2 = approximate dimension

Hose-Ø	Port size G	i	L1	L2	L3	D1	S1	D4	S4	S	Type
4,3/3	G 1/8"	6,5	24	18	11,5	8	7		14	14	156M-4,3/3S-1/8N
5/3	G 1/8"	6,5	24	18	11,5	8	7		14	14	156M-5/3S-1/8N
6/4	G 1/8"	6,5	24	21	11,5	11,5	10		14	14	156M-6/4S-1/8N
6/4	G 1/4"	8	24,5	23	11,5	11,5	10		18	17	156M-6/4S-1/4N
6/4	G 3/8"	9	25	26,5	11,5	11,5	10	21		19	156M-6/4-3/8N
6/4	G 1/2"	10	25	29	11,5	11,5	10	26		27	156M-6/4-1/2N
8/6	G 1/8"	6,5	24	21	11,5	13,5	12		14	14	156M-8/6S-1/8N
8/6	G 1/4"	8	24,5	23	11,5	13,5	12		18	17	156M-8/6S-1/4N
8/6	G 3/8"	9	25	26,5	11,5	13,5	12	21		19	156M-8/6-3/8N
8/6	G 1/2"	10	25	29	11,5	13,5	12	26		27	156M-8/6-1/2N
10/8	G 1/8"	6,5	24	22,5	11,5	15,5	13		14	14	156M-10/8S-1/8N
10/8	G 1/4"	8	24,5	24,5	11,5	15,5	13		18	17	156M-10/8S-1/4N
10/8	G 3/8"	9	25	28	11,5	15,5	13	21		19	156M-10/8-3/8N
10/8	G 1/2"	10	25	30,5	11,5	15,5	13	26		27	156M-10/8-1/2N
12/9	G 3/8"	9	25	29,5	11,5	17,5	15	21		19	156M-12/9-3/8N
12/10	G 3/8"	9	25	29,5	11,5	17,5	15	21		19	156M-12/10-3/8N
12/10	G 1/2"	10	25	32	11,5	17,5	15	26		27	156M-12/10-1/2N

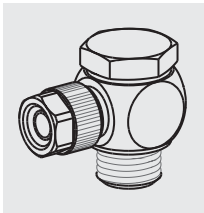

Elbow male adaptor, turn-able

Cylindrical, short
Material: brass, nickel plated
Seals: A: Aluminium
N: PA
MinimumTemp.: -40°C
Maximum pressure: 25 bar

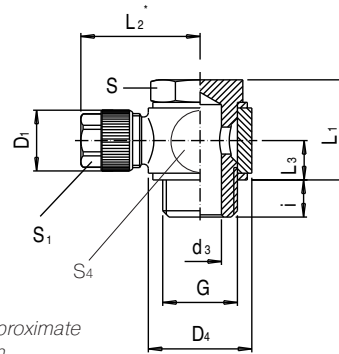

* L2 = approximate dimension

If requested with Aluminium seal, please replace the **N** in the type-number with an **A**.

Hose-Ø	Port size G	i	L1	L2	L3	D1	S1	D4	S4	S	Type
4,3/3	M 5	4	14	15,5	5	8	7		9	8	152M-4,3/3S-M5N
4,3/3	G 1/8"	6,5	20	18	8	8	7		14	14	152M-4,3/3S-1/8N
5/3	M 5	4	14	15,5	5	8	7		9	8	152M-5/3S-M5N
5/3	G 1/8"	6,5	20	18	8	8	7		14	14	152M-5/3S-1/8N
6/4	M 5	4	14	16,5	5	9	8		9	8	152M-6/4S-M5N
6/4	G 1/8"	6,5	20	21	8	11,5	10		14	14	152M-6/4S-1/8N
6/4	G 1/4"	8	21	23	8	11,5	10		18	17	152M-6/4S-1/4N
6/4	G 3/8"	9	21,5	26,5	8	11,5	10	21		19	152M-6/4-3/8N
6/4	G 1/2"	10	21,5	29	8	11,5	10	26		27	152M-6/4-1/2N
8/6	G 1/8"	6,5	20	21	8	13,5	12		14	14	152M-8/6S-1/8N
8/6	G 1/4"	8	21	23	8	13,5	12		18	17	152M-8/6S-1/4N
8/6	G 3/8"	9	21,5	26,5	8	13,5	12	21		19	152M-8/6-3/8N
8/6	G 1/2"	10	21,5	29	8	13,5	12	26		27	152M-8/6-1/2N

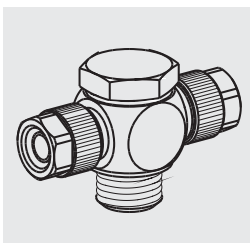

T male adaptor, turn-able

Cylindrical, short
Material: brass, nickel plated
Seals: A: Aluminium
N: PA
MinimumTemp.: -40°C
Maximum pressure: 25 bar

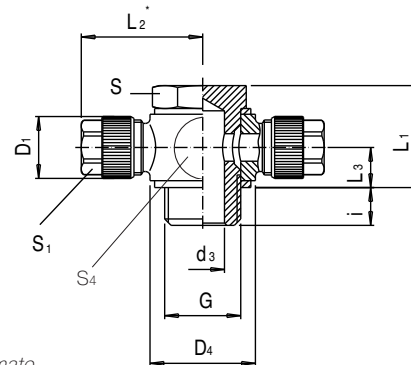

* L2 = approximate dimension

If requested with Aluminium seal, please replace the **N** in the type-number with an **A**.

Hose-Ø	Port size G	i	L1	L2	L3	D1	S1	D4	S4	S	Type
4,3/3	M 5	4	14	15,5	5	8	7		9	8	153M-4,3/3S-M5N
4,3/3	G 1/8"	6,5	20	18	8	8	7		14	14	153M-4,3/3S-1/8N
5/3	M 5	4	14	15,5	5	8	7		9	8	153M-5/3S-M5N
5/3	G 1/8"	6,5	20	19	8	8	7		14	14	153M-5/3S-1/8N
6/4	M 5	4	14	16,5	5	9	8		9	8	153M-6/4S-M5N
6/4	G 1/8"	6,5	20	21	8	11,5	10		14	14	153M-6/4S-1/8N
6/4	G 1/4"	8	21	23	8	11,5	10		18	17	153M-6/4S-1/4N
6/4	G 3/8"	9	21,5	26,5	8	11,5	10	21		19	153M-6/4-3/8N
6/4	G 1/2"	10	21,5	29	8	11,5	10	26		27	153M-6/4-1/2N
8/6	G 1/8"	6,5	20	21	8	13,5	12		14	14	153M-8/6S-1/8N
8/6	G 1/4"	8	21	23	8	13,5	12		18	17	153M-8/6S-1/4N
8/6	G 3/8"	9	21,5	26,5	8	13,5	12	21		19	153M-8/6-3/8N
8/6	G 1/2"	10	21,5	29	8	13,5	12	26		27	153M-8/6-1/2N

Push-on fittings

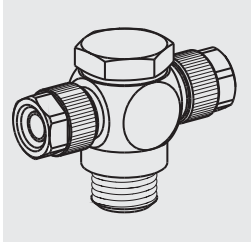

T male adaptor, turn-able

Cylindrical, long
Material: brass, nickel plated
Seals: PA
Minimum Temp.: -40°C
Maximum pressure: 25 bar

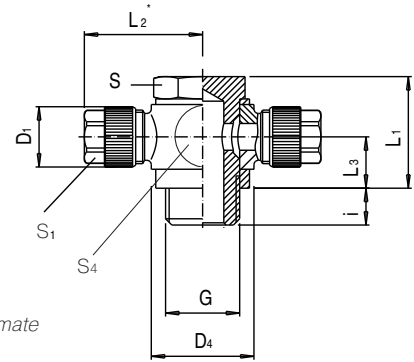

Hose-Ø	Port size G	i	L1	L2	L3	D1	S1	D4	S4	S	Type
4,3/3	G 1/8"	6,5	24	18	11,5	8	7		14	14	157M-4,3/3S-1/8N
5/3	G 1/8"	6,5	24	18	11,5	8	7		14	14	157M-5/3S-1/8N
6/4	G 1/8"	6,5	24	21	11,5	11,5	10		14	14	157M-6/4S-1/8N
6/4	G 1/4"	8	24,5	23	11,5	11,5	10		18	17	157M-6/4S-1/4N
6/4	G 3/8"	9	25	26,5	11,5	11,5	10	21		19	157M-6/4-3/8N
6/4	G 1/2"	10	25	29	11,5	11,5	10	26		27	157M-6/4-1/2N
8/6	G 1/8"	6,5	24	21	11,5	13,5	12		14	14	157M-8/6S-1/8N
8/6	G 1/4"	8	24,5	23	11,5	13,5	12		18	17	157M-8/6S-1/4N
8/6	G 3/8"	9	25	26,5	11,5	13,5	12	21		19	157M-8/6-3/8N
8/6	G 1/2"	10	25	29	11,5	13,5	12	26		27	157M-8/6-1/2N
10/8	G 1/8"	6,5	24	22,5	11,5	15,5	13		14	14	157M-10/8S-1/8N
10/8	G 1/4"	8	24,5	24,5	11,5	15,5	13		18	17	157M-10/8S-1/4N
10/8	G 3/8"	9	25	28	11,5	15,5	13	21		19	157M-10/8-3/8N
10/8	G 1/2"	10	25	30,5	11,5	15,5	13	26		27	157M-10/8-1/2N

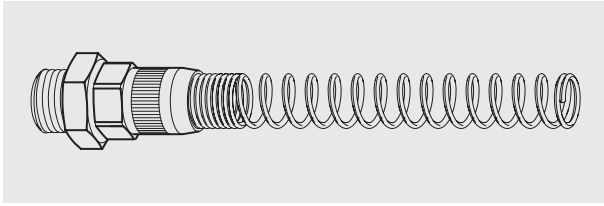

Straight male adaptor with spring

Cylindrical
Material: brass, nickel plated
Minimum Temp.: -40°C
Maximum pressure: 25 bar

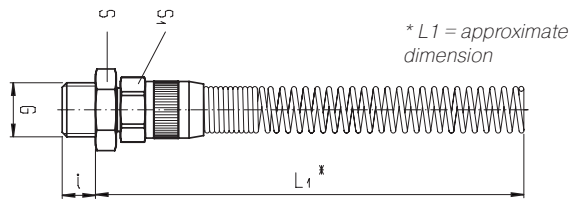

Swivel or conical versions on request,

Hose-Ø	Port size G	i	L1	S1	S	Type
6/4	G 1/8"	6	102	12	13	151M-6/4KS-1/8
6/4	G 1/4"	8	103	12	17	151M-6/4KS-1/4
6/4	G 3/8"	9	103	12	19	151M-6/4KS-3/8
6/4	G 1/2"	10	103	12	24	151M-6/4KS-1/2
8/6	G 1/8"	6	103	14	13	151M-8/6KS-1/8
8/6	G 1/4"	8	103	14	17	151M-8/6KS-1/4
8/6	G 3/8"	9	104	14	19	151M-8/6KS-3/8
8/6	G 1/2"	10	104	14	24	151M-8/6KS-1/2
10/8	G 1/8"	6	104	16	14	151M-10/8KS-1/8
10/8	G 1/4"	8	104	16	17	151M-10/8KS-1/4
10/8	G 3/8"	9	104	16	19	151M-10/8KS-3/8
10/8	G 1/2"	10	105	16	24	151M-10/8KS-1/2
12/9	G 1/4"	8	104	19	17	151M-12/9KS-1/4
12/9	G 3/8"	9	104	19	19	151M-12/9KS-3/8
12/10	G 3/8"	9	104	19	24	151M-12/10KS-3/8
12/10	G 1/2"	10	105	19	24	151M-12/10KS-1/2

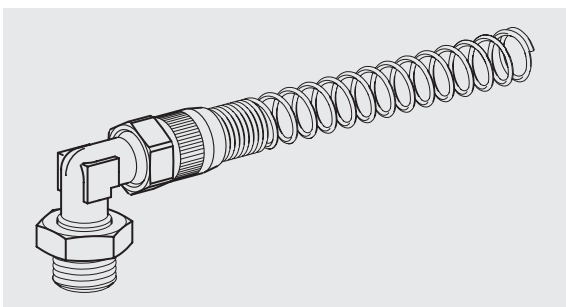

Elbow male adaptor with spring, swivel

Cylindrical
Material: brass, nickel plated
Seals: NBR
Temperature range: -20°C ... +80°C
Maximum pressure: 12 bar

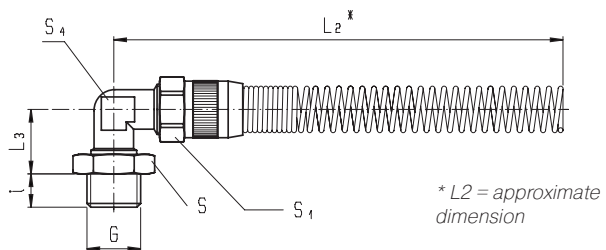

Conical versions on request.

Hose-Ø	Port size G	i	L2	L3	S1	S4	S	Type
6/4	G 1/8"	6	107	14,5	12	10	13	130M-6/4KS-1/8
6/4	G 1/4"	8	107	14,5	12	10	17	130M-6/4KS-1/4
8/6	G 1/8"	6	108	14,5	14	10	13	130M-8/6KS-1/8
8/6	G 1/4"	8	108	14,5	14	10	17	130M-8/6KS-1/4
10/8	G 1/4"	8	107	14,5	16	10	17	130M-10/8KS-1/4

Accessories

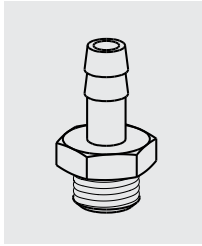

Straight male adaptor, push-on, barbed

Cylindrical

Material: brass, nickel plated

Temperature range: -40°C ... +120°C

Maximum pressure: 50 bar

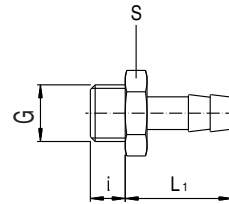

Hose-Ø (inner)	Port size G	L1	i	S	Type
1,6-2	M 5	12	4	8	260M-2-M5
2,7-3	M 5	12	4	8	260M-3-M5
3,5-4	M 5	20	4	8	260M-4-M5
5-6	G 1/8"	25	6	13	260M-7-1/8
5-6	G 1/4"	26,5	8	16	260M-7-1/4
6-7	G 1/8"	25	6	13	260M-8-1/8
6-7	G 1/4"	26,5	8	16	260M-8-1/4
7-8	G 1/8"	25	6	13	260M-9-1/8
7-8	G 1/4"	26,5	8	16	260M-9-1/4
7-8	G 3/8"	26,5	9	16	260M-9-3/8
9-10	G 1/4"	24,5	8	17	260M-10-1/4
10-11	G 1/4"	26,5	8	16	260M-12-1/4
10-11	G 3/8"	26,5	9	19	260M-12-3/8
10-11	G 1/2"	29,5	10	24	260M-12-1/2
12-13	G 1/4"	24,5	8	17	260M-14-1/4
12-13	G 3/8"	24,5	9	19	260M-14-3/8
12-13	G 1/2"	25	10	24	260M-14-1/2
15-16	G 3/8"	30,5	9	19	260M-17-3/8
15-16	G 1/2"	31,5	10	24	260M-17-1/2
18-19	G 1/2"	29,5	10	24	260M-20-1/2

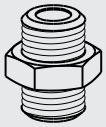

Nipple

Cylindrical
Material: brass, nickel plated
Temperature range: -40°C ...+120°C
Maximum pressure: 50 bar

Conical versions on request.

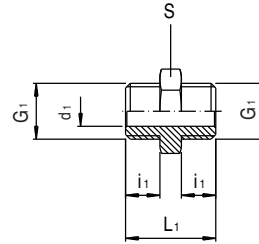

Port size G	L1	i1	d1	S	Type
M5	11,5	4	2	8	250M-M5
G 1/8"	16,5	6	5	13	250M-1/8
G 1/4"	21	8	7	17	250M-1/4
G 3/8"	23	9	10	19	250M-3/8
G 1/2"	25,5	10	13	24	250M-1/2

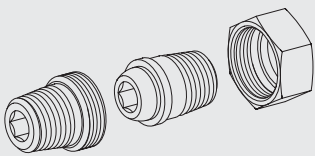

Nipple, 3-piece

Conical
Material: brass, nickel plated
Temperature range: -40°C ...+120°C
Maximum pressure: 16 bar

Non nickel plated version with NBR
O-ring-seal inside on request.

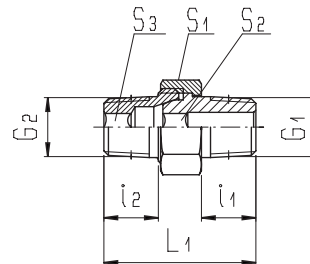

Port size G1	Port size G2	L1	i1	i2	S1	S2	S3	Type
1/8" K	1/8" K	27	9	9	15	5	5	230M-1/8K
1/4" K	1/4" K	33,5	12	12	19	6	6	230M-1/4K
3/8" K	3/8" K	36,5	13	13	22	8	8	230M-3/8K
1/2" K	1/2" K	44	16	16	27	12	12	230M-1/2K
3/4" K	3/4" K	52,5	16,5	16,5	36	14	14	230M-3/4K

Accessories

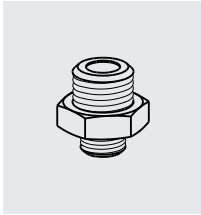

Reducing Nipple, male-male

Cylindrical

Material: brass, nickel plated

Temperature range: -40°C ... +120°C

Maximum pressure: 50 bar

Conical versions on request.

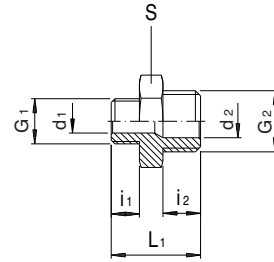

Port size G1	Port size G2	L1	i1	d1	i2	d2	S	Type
M 5	G 1/8"	14,5	4	2	6	5	14	251M-M5-1/8
G 1/8"	G 1/4"	19	6	5	8	7	17	251M-1/8-1/4
G 1/8"	G 3/8"	20	6	5	9	9,5	19	251M-1/8-3/8
G 1/8"	G 1/2"	21,5	6	5	10	13	24	251M-1/8-1/2
G 1/4"	G 3/8"	22	8	7	9	10	19	251M-1/4-3/8
G 1/4"	G 1/2"	23,5	8	7	10	13	24	251M-1/4-1/2
G 3/8"	G 1/2"	24,5	9	10	10	14	24	251M-3/8-1/2
G 1/2"	G 3/4"	27,5	10	14	12	18	30	251M-1/2-3/4

Dimensions might vary.

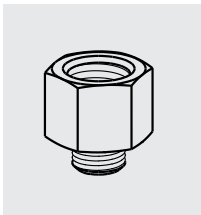

Reducer, female-male

Cylindrical

Material: brass, nickel plated

Temperature range: -40°C ... +120°C

Maximum pressure: 50 bar

Conical versions and orientating versions on request.

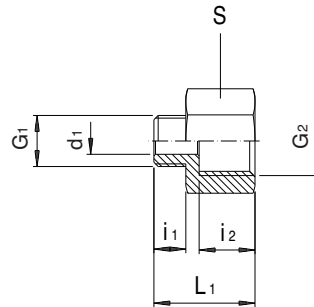

Port size G1	Port size G2	L1	i1	d1	i2	S	Type
M 5	M 5	11	4	2	5	8	252M-M5-M5
M 5	G 1/8"	14,5	4	2	8	14	252M-M5-1/8
G 1/8"	G 1/8"	17	6	6	8	14	252M-1/8-1/8
G 1/8"	G 1/4"	20,5	6	6	10,5	17	252M-1/8-1/4
G 1/8"	G 3/8"	21,5	6	6	11,5	22	252M-1/8-3/8
G 1/8"	G 1/2"	24	6	6	15	24	252M-1/8-1/2
G 1/4"	G 1/4"	22,5	8	8	10,5	17	252M-1/4-1/4
G 1/4"	G 3/8"	23,5	8	8	11,5	22	252M-1/4-3/8
G 1/4"	G 1/2"	26,5	8	8	15	26	252M-1/4-1/2
G 3/8"	G 3/8"	24,5	9	12	11,5	22	252M-3/8-3/8
G 3/8"	G 1/2"	27,5	9	12	15	26	252M-3/8-1/2
G 1/2"	G 1/2"	28,5	10	14	15	26	252M-1/2-1/2

Dimensions might vary.

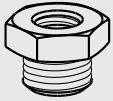

Reducer male-female

Cylindrical
Material: brass, nickel plated
Temperature range: -40°C ...+120°C
Maximum pressure: 50 bar

Conical versions on request.

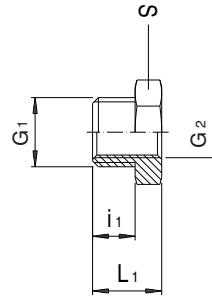

Port size G1	Port size G2	L1	i1	S	Type
G 1/8"	M 5	10,5	6	14	253M-1/8-M5
G 1/4"	G 1/8"	13	8	17	253M-1/4-1/8
G 3/8"	G 1/8"	14	9	19	253M-3/8-1/8
G 1/2"	G 1/8"	15,5	10	24	253M-1/2-1/8
G 3/8"	G 1/4"	14	9	19	253M-3/8-1/4
G 1/2"	G 1/4"	15,5	10	24	253M-1/2-1/4
G 1/2"	G 3/8"	15,5	10	24	253M-1/2-3/8
G 3/4"	G 1/2"	17,5	12	30	253M-3/4-1/2

Dimensions might vary.

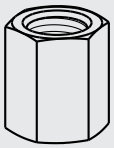

Socket, female

Cylindrical
Material: brass, nickel plated
Temperature range: -40°C ...+120°C
Maximum pressure: 50 bar

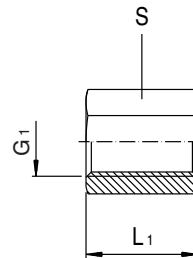

Port size G1	L1	S	Type
M 5	11	8	254M-M5
G 1/8"	15	14	254M-1/8
G 1/4"	22	17	254M-1/4
G 3/8"	24	22	254M-3/8
G 1/2"	30	26	254M-1/2
G 3/4"	32	32	254M-3/4

Dimensions might vary.

Accessories

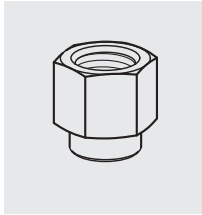

Reducer female-female

Cylindrical

Material: brass, nickel plated

Temperature range: -40°C ...+120°C

Maximum pressure: 50 bar

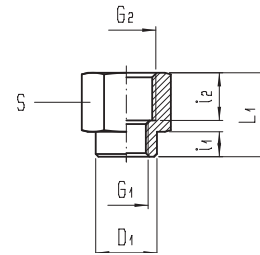

Port size G1	Port size G2	i1	i2	L1	D1	S	Type
M 5	G 1/8"	5	8	13	8	14	255M-M5-1/8
G 1/8"	G 1/4"	8	10,5	19	13,5	17	255M-1/8-1/4
G 1/8"	G 3/8"	8	11,5	20	13,5	22	255M-1/8-3/8
G 1/8"	G 1/2"	8	15	24	13,5	24	255M-1/8-1/2
G 1/4"	G 3/8"	10,5	11,5	23	17	22	255M-1/4-3/8
G 1/4"	G 1/2"	10,5	15	25	17	24	255M-1/4-1/2
G 3/8"	G 1/2"	11,5	15	27,5	21	24	255M-3/8-1/2
G 1/2"	G 3/4"	12,5	16,5	30	26	30	255M-1/2-3/4

Dimensions might vary.



Plug

Conical

Material: brass

Temperature range: -40°C ...+120°C

Maximum pressure: 50 bar

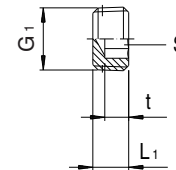

Csatlakozás G1	L1	t	S	Típuszám
1/8" K	7.5	5	5	257U-1/8K
1/4" K	10	7	6	257U-1/4K
3/8" K	11	7	8	257U-3/8K
1/2" K	13	8	10	257U-1/2K

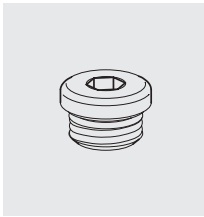

Male plug with O-ring seal

Cylindrical

Material: brass, nickel plated

Seal: NBR

Temperature range: -20°C ...+80°C

Maximum pressure: 50 bar

Long version (DIN 908) without seal in brass or steel on request.

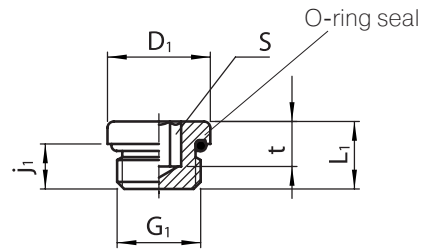

Port size G1	i1	L1	D1	S	Type
M 5	4	6	8	2	262M-M5
G 1/8"	6	8,5	14	5	262M-1/8
G 1/4"	8	11	17	6	262M-1/4
G 3/8"	9	12,5	20	8	262M-3/8
G 1/2"	10	13,5	25	10	262M-1/2

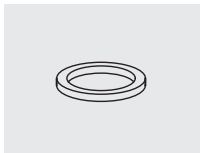

Sealing ring

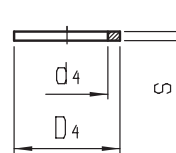

Port size	Material	Max. Temperature	D4	d4	s	Type
M 5	PVC	70°C	8	5,1	1	269N-M5x1,0
G 1/8" + M 10	PVC	70°C	14	10	1,5	269N-1/8x1,5
G 1/4"	PVC	70°C	17,5	13,5	1,5	269N-1/4x1,5
G 3/8"	PVC	70°C	21	16,7	1,5	269N-3/8x1,5
G 1/2"	PVC	70°C	26	21,3	1,5	269N-1/2x1,5
G 1/8" + M 10	Fiber	90°C	14	10	1,5	264V-1/8x1,5
G 1/4"	Fiber	90°C	17,5	13,5	1,5	264V-1/4x1,5
G 3/8"	Fiber	90°C	21	16,7	1,5	264V-3/8x1,5
G 1/2"	Fiber	90°C	25	21,3	1,5	264V-1/2x1,5
M 5	Alu	120°C	7,5	5,1	0,5	265A-M5x0,5
M 5	Alu	120°C	7,5	5,1	1	265A-M5x1,0
M 5	Alu	120°C	8	5,1	1,5	265A-M5x1,5
G 1/8" + M 10	Alu	120°C	14	10,3	1,5	265A-1/8x1,5
G 1/4"	Alu	120°C	17,5	13,5	1,5	265A-1/4x1,5
G 3/8"	Alu	120°C	21	16,7	1,5	265A-3/8x1,5
G 1/2"	Alu	120°C	25	21,3	1,5	265A-1/2x1,5
G 3/4"	Alu	120°C	32	27,2	1,5	265A-3/4x1,5

Airline Adaptors

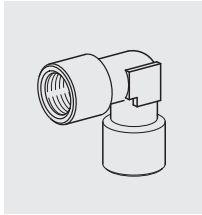

Elbow, female

Cylindrical

Material: brass, nickel plated

Temperature range: -40°C ...+120°C

Maximum pressure: 50 bar

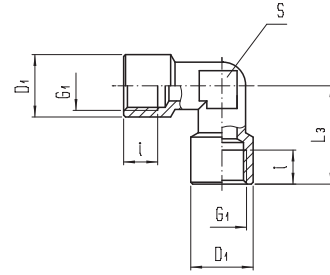

Port size G1	i	L3	D1	S	Type
G 1/8"	8,5	21	14	11	201M-1/8
G 1/4"	11	25,5	17	13	201M-1/4
G 3/8"	11,5	28	21	17	201M-3/8
G 1/2"	15	32	26,5	20	201M-1/2
G 3/4"	16,5	36,5	32	27	201M-3/4
G 1"	19	45	39	30	201M-1

Dimensions might vary.

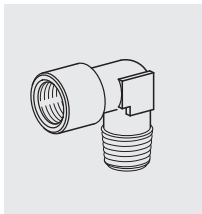

Elbow, female-male

Conical - Cylindrical

Material: brass, nickel plated

Temperature range: -40°C ...+120°C

Maximum pressure: 50 bar

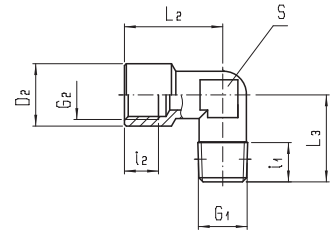

Port size G1	Port size G2	i1	i2	L2	L3	D2	S	Type
1/8" K	G 1/8"	7,5	8,5	21	18,5	14	11	202M-1/8K-1/8
1/4" K	G 1/4"	11	11	25,5	24	17	13	202M-1/4K-1/4
3/8" K	G 3/8"	11,5	12	28	27	21	17	202M-3/8K-3/8
1/2" K	G 1/2"	14	15	32	29,5	26,5	20	202M-1/2K-1/2
3/4" K	G 3/4"	14,5	16,5	36,5	32	32	27	202M-3/4K-3/4
1" K	G 1"	16	19	45	39	39	30	202M-1K-1

Dimensions might vary.

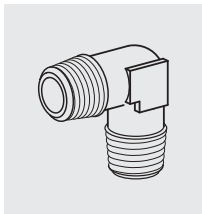

Elbow, male

Conical

Material: brass, nickel plated

Temperature range: -40°C ...+120°C

Maximum pressure: 50 bar

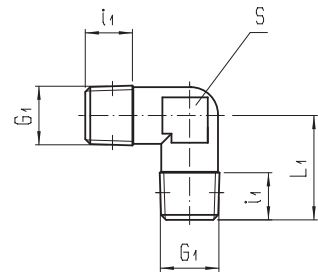

Port size G1	i1	L1	S	Type
1/8" K	7,5	18	11	204M-1/8K
1/4" K	11	24	13	204M-1/4K
3/8" K	12	27	17	204M-3/8K
1/2" K	14	29,5	20	204M-1/2K
3/4" K	14,5	32	27	204M-3/4K
1" K	16,8	39	30	204M-1K

Dimensions might vary.

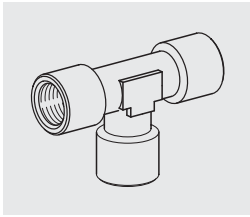

T, female

Cylindrical
Material: brass, nickel plated
Temperature range: -40°C ...+120°C
Maximum pressure: 50 bar

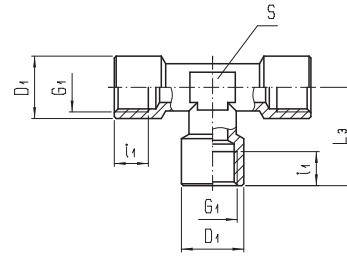

Port size G1	i1	L3	D1	S	Type
G 1/8"	8,5	19,5	14	12	200M-1/8
G 1/4"	11	24,5	17	13	200M-1/4
G 3/8"	12	27	21	16	200M-3/8
G 1/2"	15	32	26,5	20	200M-1/2
G 3/4"	16,5	36,5	32	27	200M-3/4
G 1"	19	45	39	30	200M-1

Dimensions might vary.

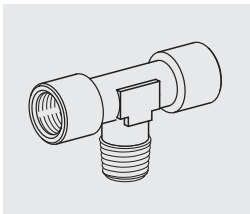

T, male- female-female

Conical - Cylindrical - Cylindrical,
Material: brass, nickel plated
Temperature range: -40°C ...+120°C
Maximum pressure: 50 bar

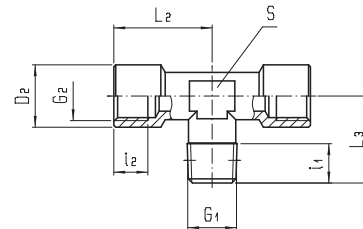

Port size G1	Port size G2	i1	i2	L2	L3	D2	S	Type
1/8" K	G 1/8"	8	8,5	19,5	17,5	14	12	206M-1/8K-1/8
1/4" K	G 1/4"	11	11	24,5	23	17	13	206M-1/4K-1/4
3/8" K	G 3/8"	11,5	12	27	25,5	21	16	206M-3/8K-3/8
1/2" K	G 1/2"	14	15	32	29	26,5	20	206M-1/2K-1/2
3/4" K	G 3/4"	14,5	16,5	36,5	32	32	27	206M-3/4K-3/4
1" K	G 1"	16,8	19	45	39	39	30	206M-1K-1

Dimensions might vary.

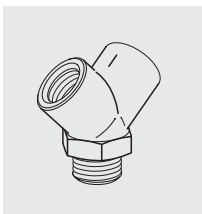

Y, male-female-female

Conical - Cylindrical - Cylindrical
Material: brass, nickel plated
Temperature range: -40°C ...+120°C
Maximum pressure: 50 bar

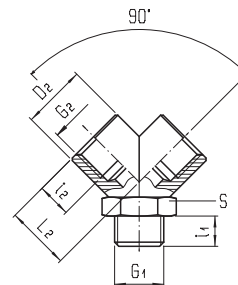

Port size G1	Port size G2	i1	i2	L2	D2	S	Type
1/8" K	G 1/8"	9	8	15	14	14	216M-1/8K-1/8
1/4" K	G 1/4"	11	11	17	17	17	216M-1/4K-1/4
3/8" K	G 3/8"	12,5	11,5	18	21	22	216M-3/8K-3/8
1/2" K	G 1/2"	16,5	14	25	26,5	26	216M-1/2K-1/2

Dimensions might vary.

Airline Adaptors

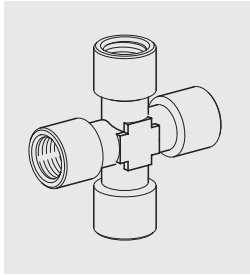

Cross, female

Cylindrical

Material:

brass, nickel plated

Temperature range: -40°C ...+120°C

Maximum pressure: 50 bar

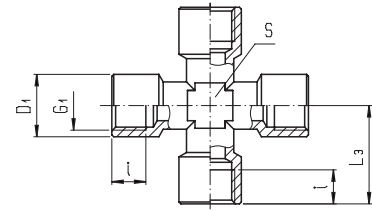

Port size G1	i1	L3	D1	S	Type
G 1/8"	8,5	19,5	14	11	203M-1/8
G 1/4"	11	25	17	13	203M-1/4
G 3/8"	12	28	21	17	203M-3/8
G 1/2"	15	32	26,5	20	203M-1/2

Dimensions might vary.

*This is only a selection of Airline Adaptors.
Numerous other version are available on request.*

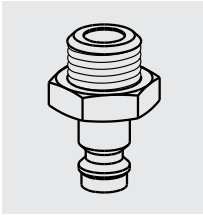

Straight plug, male

Cylindrical
Material: brass, nickel plated
Temperature range: -20°C ...+80°C
Maximum pressure: 16 bar

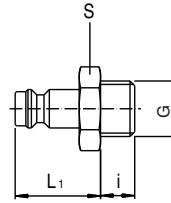

Orifice	Port-size G	i	L1	S	Type
5	G 1/8"	6	18,5	13	515M-1/8
5	G 1/4"	8	19	17	515M-1/4
8	G 1/4"	8	25	17	518M-1/4
8	G 3/8"	9	25	19	518M-3/8
8	G 1/2"	10	25,5	24	518M-1/2

S 24 = octagonal

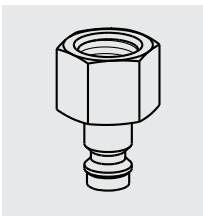

Straight plug, female

Cylindrical
Material: brass, nickel plated
Temperature range: -20°C ...+80°C
Maximum pressure: 16 bar

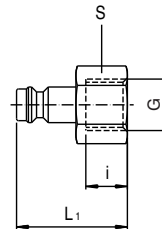

Orifice	Port-size G	i	L1	S	Type
5	G 1/8"	8	24	13	535M-1/8
5	G 1/4"	10,5	27	17	535M-1/4
8	G 1/4"	10,5	33	17	538M-1/4
8	G 3/8"	11,5	34	19	538M-3/8
8	G 1/2"	15	38	24	538M-1/2

S 24 = octagonal

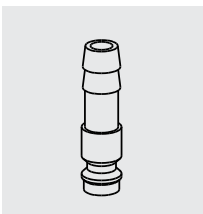

Straight plug, push-on, barbed

Material: brass, nickel plated
Temperature range: -20°C ...+80°C
Maximum pressure: 16 bar

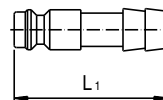

Orifice	Hose-Ø (inner)	L1	Type
5	4 - 5	33,5	565M-6
5	7 - 8	33,5	565M-9
8	4 - 5	39,5	568M-6
8	7 - 8	39,5	568M-9
8	10 - 11	39,5	568M-12
8	12 - 13	39,5	568M-14

Automatic Quick couplings

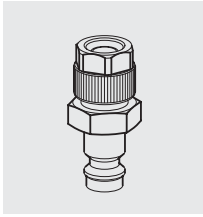

Straight plug, push-on

Material: brass, nickel plated
 Temperature range: -20°C ...+80°C
 Maximum pressure: 16 bar

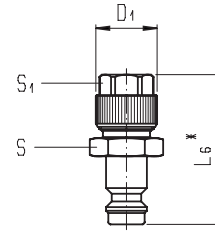

* approximate

Orifice	Hose-Ø	L6	D1	S1	S	Type
5	6/4	33	11,5	10	12	545M-6/4
5	8/6	33	13,5	12	14	545M-8/6
8	8/6	39	13,5	12	14	548M-8/6
8	10/8	40,5	15,5	13	14	548M-10/8

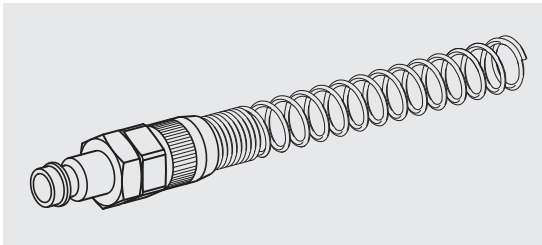

Straight plug, push-on with spiral

Material: brass, nickel plated
 Temperature range: -20°C ...+80°C
 Maximum pressure: 16 bar

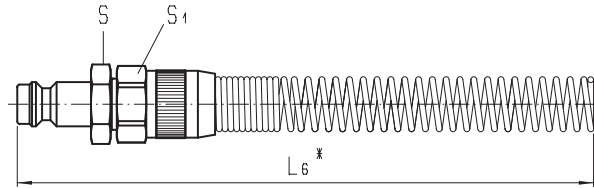

* approximate

Orifice	Hose-Ø	L6	S1	S	Type
5	6/4	118	12	12	585M-6/4
5	8/6	119	14	14	585M-8/6
8	8/6	125	14	14	588M-8/6
8	10/8	125	16	14	588M-10/8

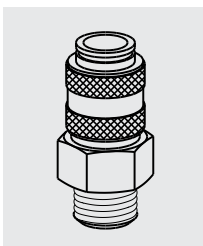

Straight socket, male

Cylindrical
 Material: brass, nickel plated
 Temperature range: -20°C ...+80°C
 Maximum pressure: 16 bar

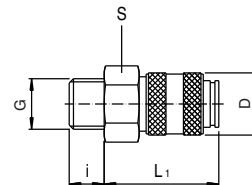

Orifice	Port size G	i	L1	D	S	Typew
5	G 1/8"	7	30	17	14	551M-1/8
5	G 1/4"	9	29	17	17	551M-1/4
8	G 1/4"	9	31	27	22	581M-1/4
8	G 3/8"	10	31	27	22	581M-3/8
8	G 1/2"	10	31	27	24	581M-1/2

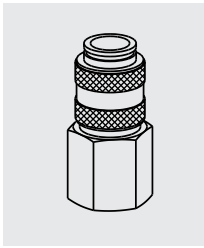

Straight socket, female

Cylindrical
Material: brass, nickel plated
Temperature range: -20°C ...+80°C
Maximum pressure: 16 bar

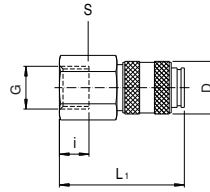

Orifice	Port size G	i	L1	D	S	Type
5	G 1/8"	9	37	17	14	553M-1/8
5	G 1/4"	9	38	17	17	553M-1/4
8	G 1/4"	9	41	27	22	583M-1/4
8	G 3/8"	9	41	27	22	583M-3/8
8	G 1/2"	10	41	27	24	583M-1/2

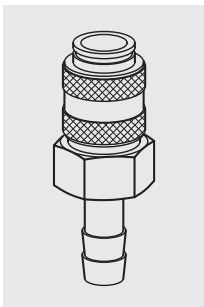

Straight socket, push-on, barbed

Material: brass, nickel plated
Temperature range: -20°C ...+80°C
Maximum pressure: 16 bar

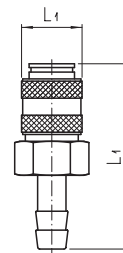

Orifice	Hose-Ø (inner)	L1	D	Type
8	4 - 5	55	27	586M-6
8	7 - 8	55	27	586M-9
8	12 - 13	55	27	586M-14

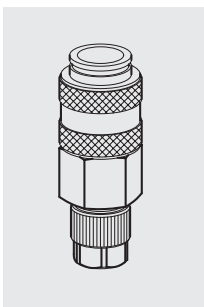

Straight socket, push-on

Material: brass, nickel plated
Temperature range: -20°C ...+80°C
Maximum pressure: 16 bar

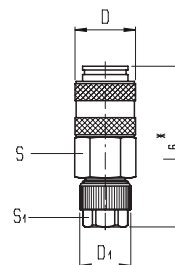

Orifice	Hose-Ø	L6	D	D1	S1	S	Type
5	6/4	44,5	17	11,5	10	14	554M-6/4
5	8/6	44,5	17	13,5	12	14	554M-8/6

Silencers

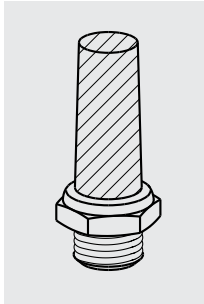

Silencer, long

Cylindrical
Material: sintered bronze
Temperature range: -40°C ...+130°C
Maximum pressure: 10 bar

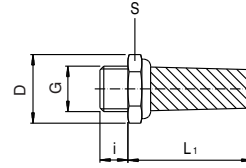

Port size G	L1	i	D	S	Type
M 5	14	4	8	7	293U-M5
G 1/8"	21	6	16	13	293U-1/8
G 1/4"	27	8	19,5	17	293U-1/4
G 3/8"	34	8	25	19	293U-3/8
G 1/2"	58	10	31	24	293U-1/2
G 3/4"	65	15	37	32	293U-3/4
G 1"	68	12	44	36	293U-1

Dimensions might vary.

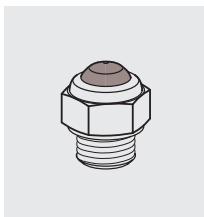

Silencer, short

Cylindrical
Material: brass, sintered bronze
Temperature range: -40°C ...+130°C
Maximum pressure: 10 bar

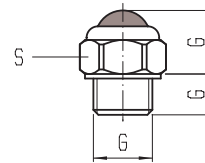

Port size G	L1	i	S	Type
G 1/8"	8,5	6	13	290U-1/8
G 1/4"	11	8	16	290U-1/4
G 3/8"	11,5	8	19	290U-3/8
G 1/2"	14,5	9	24	290U-1/2
G 3/4"	15,5	10	30	290U-3/4

Dimensions might vary.

*Other types of silencers are available on request.
Flow-control silencers are displayed on page 4.7.4.*

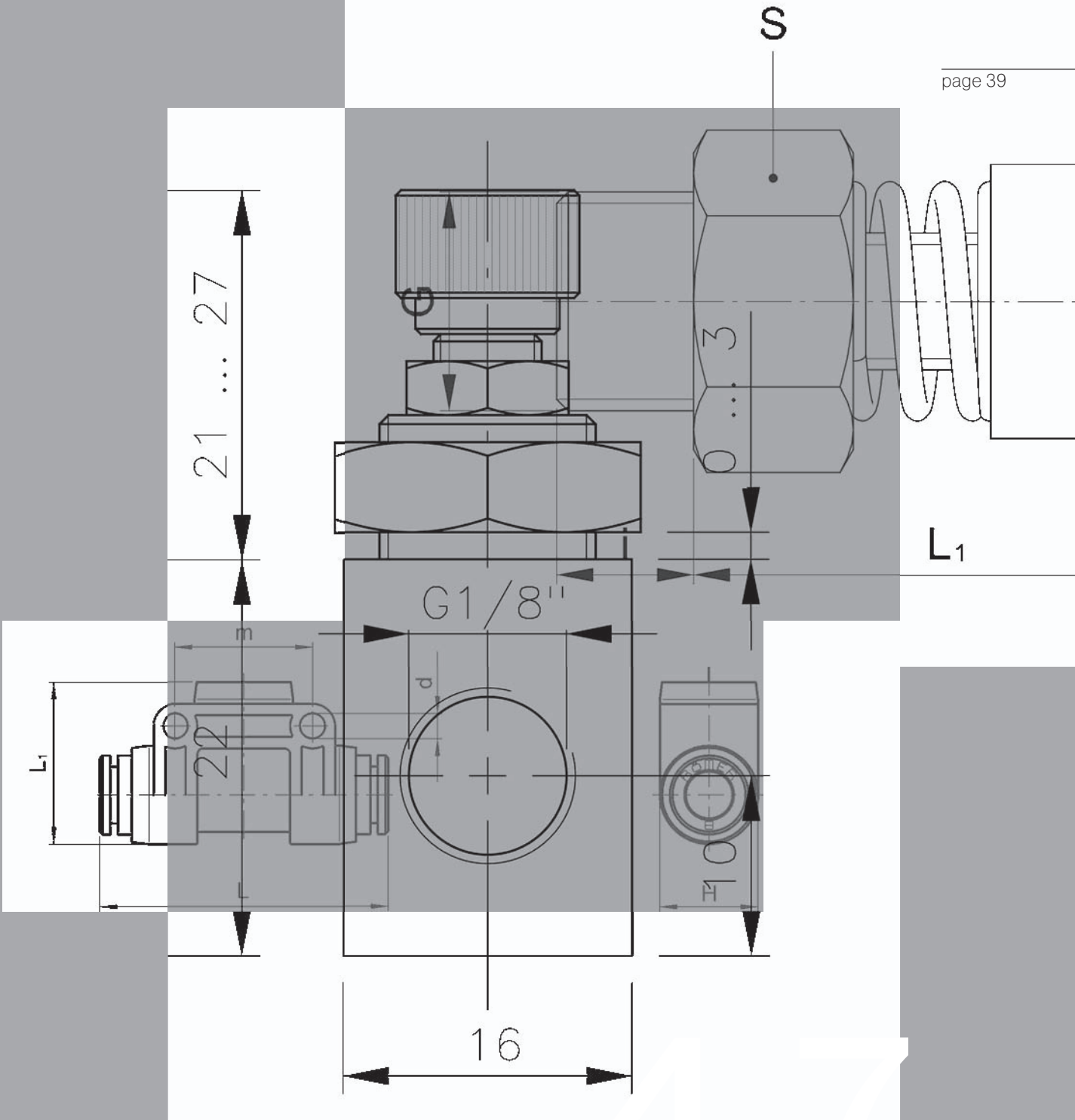

Function Fittings

Function Fittings

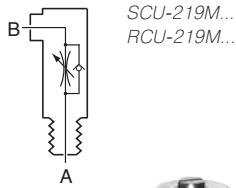

SCU-219M...
RCU-219M...

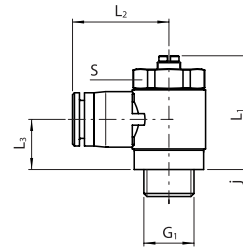

SCU...

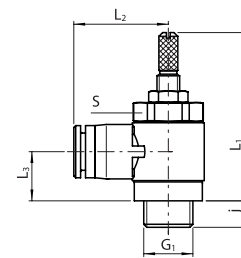

RCU...

SCU.../RCU
Exhaust-Air flow control
(one-directional, cylinder-side)

SCU operated with a screw-driver
RCU operated manually

Material valve: brass, nickel plated
Material fitting: POM
Pressure range: 0,2 ... 10 bar
Temperature range: -10°C ...+80°C

Other versions to be ordered in same dimensions:

SUC /RUC one-directional, valve-side
SCO/RCO bi-directional

Other versions especially other hose connection (push-on, screw-in) are available on request.

Type	Orifice	Air flow	Port size	Hose-Ø	i	L1max	L2	L3	S
SCU-219M-M5N-4P	1,5	0 - 70 l/min	M 5	4	4	21,5	17,5	7,5	8
SCU-219M-M5N-6P	1,5	0 - 70 l/min	M 5	6	4	21,5	18,5	7,5	8
SCU-219M-1/8N-4P	2,5	0 - 280 l/min	G 1/8"	4	5	30	22	12	14
SCU-219M-1/8N-6P	2,5	0 - 280 l/min	G 1/8"	6	5	30	22,5	12	14
SCU-219M-1/8N-8P	2,5	0 - 280 l/min	G 1/8"	8	5	30	23	12	14
SCU-219M-1/4N-6P	4,5	0 - 400 l/min	G 1/4"	6	6,5	32	24,5	13	17
SCU-219M-1/4N-8P	4,5	0 - 400 l/min	G 1/4"	8	6,5	32	25	13	17
SCU-219M-3/8N-10P-A	6,5	0 - 1000 l/min	G 3/8"	10	8,5	34	30,5		20
SCU-219M-3/8N-12P-A	6,5	0 - 1000 l/min	G 3/8"	12	8,5	34	32,5		20
SCU-219M-1/2N-12P-A	7	0 - 1250 l/min	G 1/2"	12	10	37	35		24
RCU-219M-M5-4P-A	1,5	0 - 70 l/min	M 5	4	5,5	37,5	19,5		8
RCU-219M-M5-6P-A	1,5	0 - 70 l/min	M 5	6	5,5	37,5	21		8
RCU-219M-1/8N-4P	2,5	0 - 280 l/min	G 1/8"	4	5	44	22	12	14
RCU-219M-1/8N-6P	2,5	0 - 280 l/min	G 1/8"	6	5	44	22,5	12	14
RCU-219M-1/8N-8P	2,5	0 - 280 l/min	G 1/8"	8	5	44	23	12	14
RCU-219M-1/4N-6P	4,5	0 - 400 l/min	G 1/4"	6	6,5	47	24,5	13	17
RCU-219M-1/4N-8P	4,5	0 - 400 l/min	G 1/4"	8	6,5	47	25	13	17
RCU-219M-3/8N-10P-A	6,5	0 - 1000 l/min	G 3/8"	10	8,5	56,5	30,5		20
RCU-219M-3/8N-12P-A	6,5	0 - 1000 l/min	G 3/8"	12	8,5	56,5	32,5		20
RCU-219M-1/2N-12P-A	7	0 - 1250 l/min	G 1/2"	12	10	59	35		24

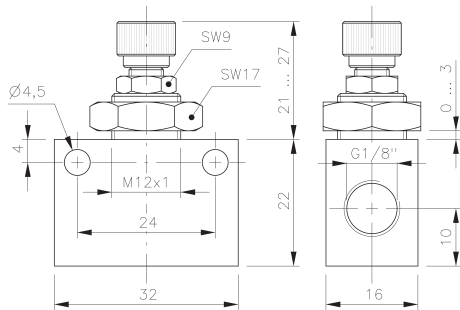

DR 501/D 501

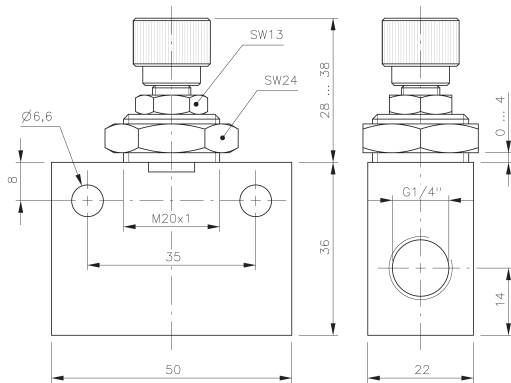

DR 801/D 801

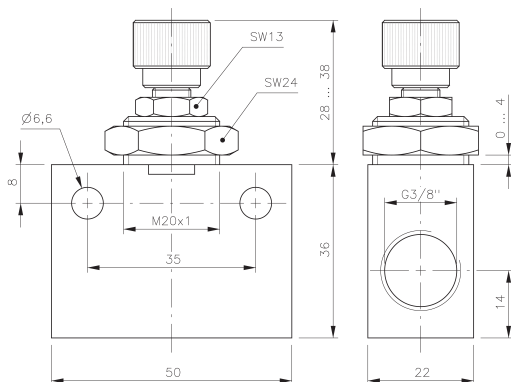

DR 101/D 101



Block form flow regulator.

Type DR: uni-directional block form flow regulator. Air streaming in the direction of the throttle can be regulated by turning the spindle. In the opposite direction air streams unthrottled.

Type D: bi-directional flow regulator. Air is regulated in both directions.

The throttle can be adjusted very precisely along the entire regulation range.

Adjustment can be locked.

Suitable for wall and panel mounting.
Nut is included.

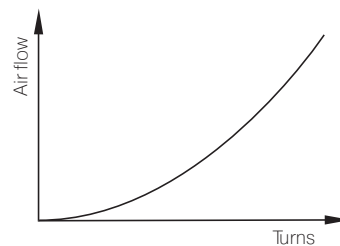

Model	Port size	Air flow	Airflow in opposite direction	Operating press.	Weight
D_501	G 1/8"	450 l/min	450 l/min	0,5 - 10 bar	0,04 kg
D_801	G 1/4"	1150 l/min	1150 l/min	0,5 - 10 bar	0,13 kg
D_101	G 3/8"	1450 l/min	1450 l/min	0,5 - 10 bar	0,13 kg

Function Fittings



VNR-958...
VNR-133...
VSR-333...

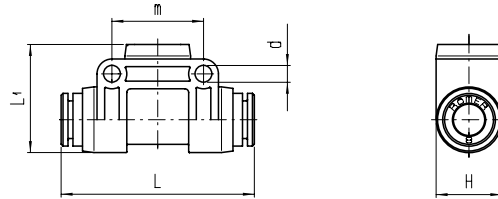

VNR-958...

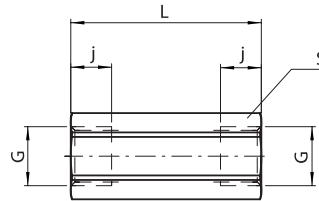

VNR-133...

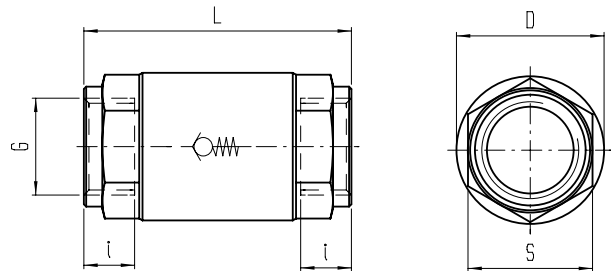

VSR-333...

VNR 958 _ _ _
Non-return valve
popped check valve

Material valve: POM
Pressure range: 0,2 ... 10 bar
Temperature range: -10°C ... +60°C
Use: Compressed air only

VNR-133 _ _ _
Non-return valve
ball check valve

Material valve: brass, nickel plated
Pressure range: 0,2 ... 16 bar
Temperature range: -10°C ... +90°C
Use: Neutral medium

VSR-333 _ _ _
Non-return valve
popped check valve

Material valve: brass, nickel plated
Pressure range: 0,2 ... 16 bar
Temperature range: -10°C ... +90°C
Use: Neutral medium

Type	Orifice	Air flow	Hose-Ø	Port-size	i	L	L1	H	m	d	S/D
VNR-958 P45-4	4,5	max. 330 l/min	4			49	28,5	17	24	4	
VNR-958 P45-6	4,5	max. 330 l/min	6			50	28,5	17	24	4	
VNR-958 P45-8	4,5	max. 330 l/min	8			50,5	28,5	17	24	4	
VNR-133-M40-1/8B	4	Kv. 0,5 m3/h		G 1/8"	8	35					13
VNR-133-M60-1/4B	6	Kv. 0,9 m3/h		G 1/4"	9	44					17
VSR-333-3/8	10			G 3/8"	11	50					19
VSR-333-1/2	15			G 1/2"	13	55					23
VSR-333-3/4	20			G 3/4"	14	62					29
VSR-333-1	25			G 1"	17	72					35

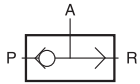

SEA... **SEA** ___
Quick exhaust valve



Material valve: brass, nickel plated, NBR
 Pressure range: 0,3 ... 10 bar
 Temperature range: -18°C ... +70°C
 Use: Compressed air only

On request: Block-form flow regulators made from aluminium, port size G1/8", G1/4", G1/2".

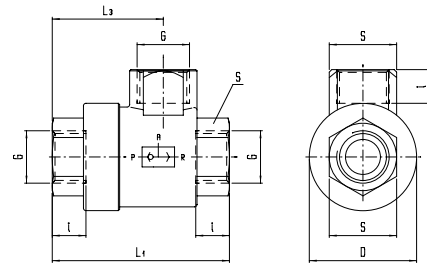

SEA...

Type	Air flow	Port size	L1	S	D
SEA-M5-A	110 l/min	M 5	25	17	24
SEA-G1/8-A	680 l/min	G 1/8"	42	15	29
SEA-G1/4-A	1200 l/min	G 1/4"	54	19	34
SEA-G3/8-A	2300 l/min	G 3/8"	60,5	22	40
SEA-G1/2-A	3500 l/min	G 1/2"	72	26	45
SEA-G3/4-A	4000 l/min	G 3/4"	88	32	50



SSC-219M...
SVE... **SSC** ___
SVE ___
Flow control silencer



Material valve: brass,
 Material silencer: sintered bronze
 Pressure range: 0 ... 12 bar
 Temperature range: -10°C ... +80°C
 Use: Compressed air only

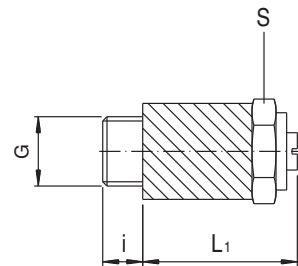

SSC...

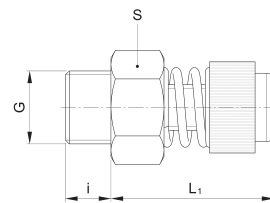

SVE...

Type	Orifice	Air flow	Port size	i	L1	S
SSC-219M-1/8	2,5	max.320 l/min	G 1/8"	5	30	14
SSC-219M-1/4	4,5	max.650 l/min	G 1/4"	7,5	31	17
SVE-1/8-C			G 1/8"	6	22	
SVE-1/4-C			G 1/4"	8	24	
SVE-3/8-C			G 3/8"	10	28	
SVE-1/2-C			G 1/2"	11	29	
SVE-3/8-C			G 3/8"	12	37	

Pneumatic tube



PUR Tube

Material: PUR (Polyurthane)
 Temperature range: -35°C ...+65°C
 Standard length: 50 m

Other colours or dimensions on request.

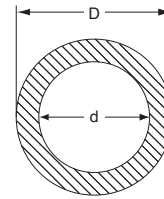

Tube diameter		Pressure range [bar]			Colour	Type
D	d	-35°C...+20°C	+40°C	+60°C		
4	2	21	16	13	black	CPU 4/2 F
4	2	21	16	13	blue	CPU 4/2 K
4	2	21	16	13	white	CPU 4/2 N
4	2,5	15	11	9	black	CPU 4/2,5 F
4	2,5	15	11	9	blue	CPU 4/2,5 K
4	2,5	15	11	9	white	CPU 4/2,5 N
5	3	16	12	10	black	CPU 5/3 F
5	3	16	12	10	blue	CPU 5/3 K
5	3	16	12	10	white	CPU 5/3 N
6	4	14	11	9	black	CPU 6/4 F
6	4	14	11	9	blue	CPU 6/4 K
6	4	14	11	9	white	CPU 6/4 N
8	6	12	9	7	black	CPU 8/6 F
8	6	12	9	7	blue	CPU 8/6 K
8	6	12	9	7	white	CPU 8/6 N
10	8	9	7	6	black	CPU 10/8 F
10	8	9	7	6	blue	CPU 10/8 K
10	8	9	7	6	white	CPU 10/8 N
12	9	10	8	6	black	CPU 12/9 F
12	9	10	8	6	blue	CPU 12/9 K
12	9	10	8	6	white	CPU 12/9 N
14	11	8	6	5	black	CPU 14/11 F
14	11	8	6	5	blue	CPU 14/11 K
14	11	8	6	5	white	CPU 14/11 N

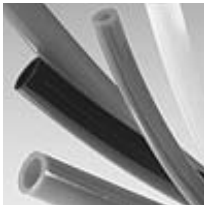

PA Tube

Material: PA (Poliamide)
 Temperature range: -60°C ...+100°C
 Standard length: 50 m

Other colours or dimensions on request.

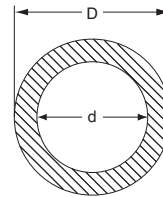

Tube diameter		Pressure range [bar]			Colour	Type
D	d	-60°C...+23°C	+40°C	+80°C		
4	2	44	33	21	black	CPA 4/2 F
4	2	44	33	21	blue	CPA 4/2 K
4	2	44	33	21	white	CPA 4/2 N
4	2,5	31	23	15	black	CPA 4/2,5 F
4	2,5	31	23	15	blue	CPA 4/2,5 K
4	2,5	31	23	15	white	CPA 4/2,5 N
5	3	34	25	16	black	CPA 5/3 F
5	3	34	25	16	blue	CPA 5/3 K
5	3	34	25	16	white	CPA 5/3 N
6	4	27	20	13	black	CPA 6/4 F
6	4	27	20	13	blue	CPA 6/4 K
6	4	27	20	13	white	CPA 6/4 N
8	6	19	14	9	black	CPA 8/6 F
8	6	19	14	9	blue	CPA 8/6 K
8	6	19	14	9	white	CPA 8/6 N
10	8	15	11	7	black	CPA 10/8 F
10	8	15	11	7	blue	CPA 10/8 K
10	8	15	11	7	white	CPA 10/8 N
12	9	19	14	9	black	CPA 12/9 F
12	9	19	14	9	blue	CPA 12/9 K
12	9	19	14	9	white	CPA 12/9 N
12	10	12	9	6	black	CPA 12/10 F
12	10	12	9	6	blue	CPA 12/10 K
12	10	12	9	6	white	CPA 12/10 N
14	11	16	12	8	black	CPA 14/11 F
14	11	16	12	8	blue	CPA 14/11 K
14	11	16	12	8	white	CPA 14/11 N
16	13	14	10	7	black	CPA 16/13 F
16	13	14	10	7	blue	CPA 16/13 K
16	13	14	10	7	white	CPA 16/13 N
22	18	13	10	6	black	CPA 22/18 F
22	18	13	10	6	blue	CPA 22/18 K
22	18	13	10	6	white	CPA 22/18 N

Pneumatic tube

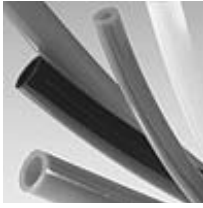

PTFE Tube

Material: PTFE
 Temperature range: -200°C ...+260°C
 Standard length: 50 m

Other dimensions on request.

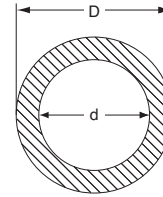

Tube diameter		Pressure range [bar]			Colour	Type
D	d	...+20°C	+75°C	+150°C		
4	2	20	15	11	white	CPT 4/2 N
5	3	15	12	8	white	CPT 5/3 N
6	4	12	9	6	white	CPT 6/4 N
8	6	9	7	5	white	CPT 8/6 N
10	8	7	5	4	white	CPT 10/8 N
12	10	6	5	3	white	CPT 12/10 N

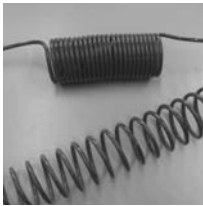

Spiral Tube

Material: PA
 Temperature range: -60°C ...+160°C
 Standard length: L = 5 m and 7,5 m

Other dimensions on request.

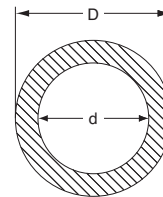

Tube diameter		L [m]	Pressure range [bar]			Colour	Type
D	d		-60°C...+23°C	+40°C	+80°C		
6	4	5	27	20	13	blue	SPA 6/4-5m
8	6	5	19	14	9	blue	SPA 8/6-5m
10	8	5	15	11	7	blue	SPA 10/8-5m
12	9	5	19	14	9	blue	SPA 12/9-5m
6	4	7,5	27	20	13	blue	SPA 6/4-7,5m
8	6	7,5	19	14	9	blue	SPA 8/6-7,5m
10	8	7,5	15	11	7	blue	SPA 10/8-7,5m
12	9	7,5	19	14	9	blue	SPA 12/9-7,5m

Hafner-Pneumatik Krämer KG
Stammheimer Straße 10

D-70806 Kornwestheim

Phone +49 - 71 54 - 82 72 60
Fax +49 - 71 54 - 82 72 68

info@hafner-pneumatik.de
www.hafner-pneumatik.de

Hafner Pneumatika Kft.
Püski út 3.

H-9228 Halászi

Phone +36 - 96 - 57 30 12
Fax +36 - 96 - 21 06 15

ertekezesites@hafner-pneumatika.com
www.hafner-pneumatika.com